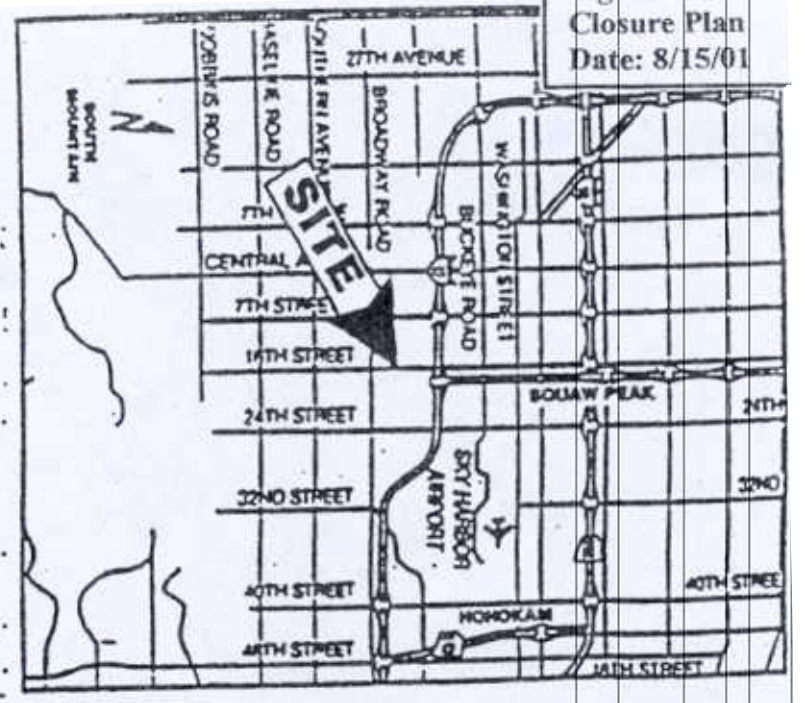

Figure 1  
 Closure Plan  
 Date: 8/15/01



**LIGHTING RESOURCES, INC.**  
*Group and Bulbless Disposal*

Lighting  
 General  
 Commercial  
 Residential  
 Construction  
 Specialties  
 Specialties

**BEN MECHE**  
 Branch Manager

1522 E. Victory Street, Suite 104  
 Phoenix, Arizona 85040

(602) 278-4278  
 (602) 572-8253  
 Fax (602) 278-6432

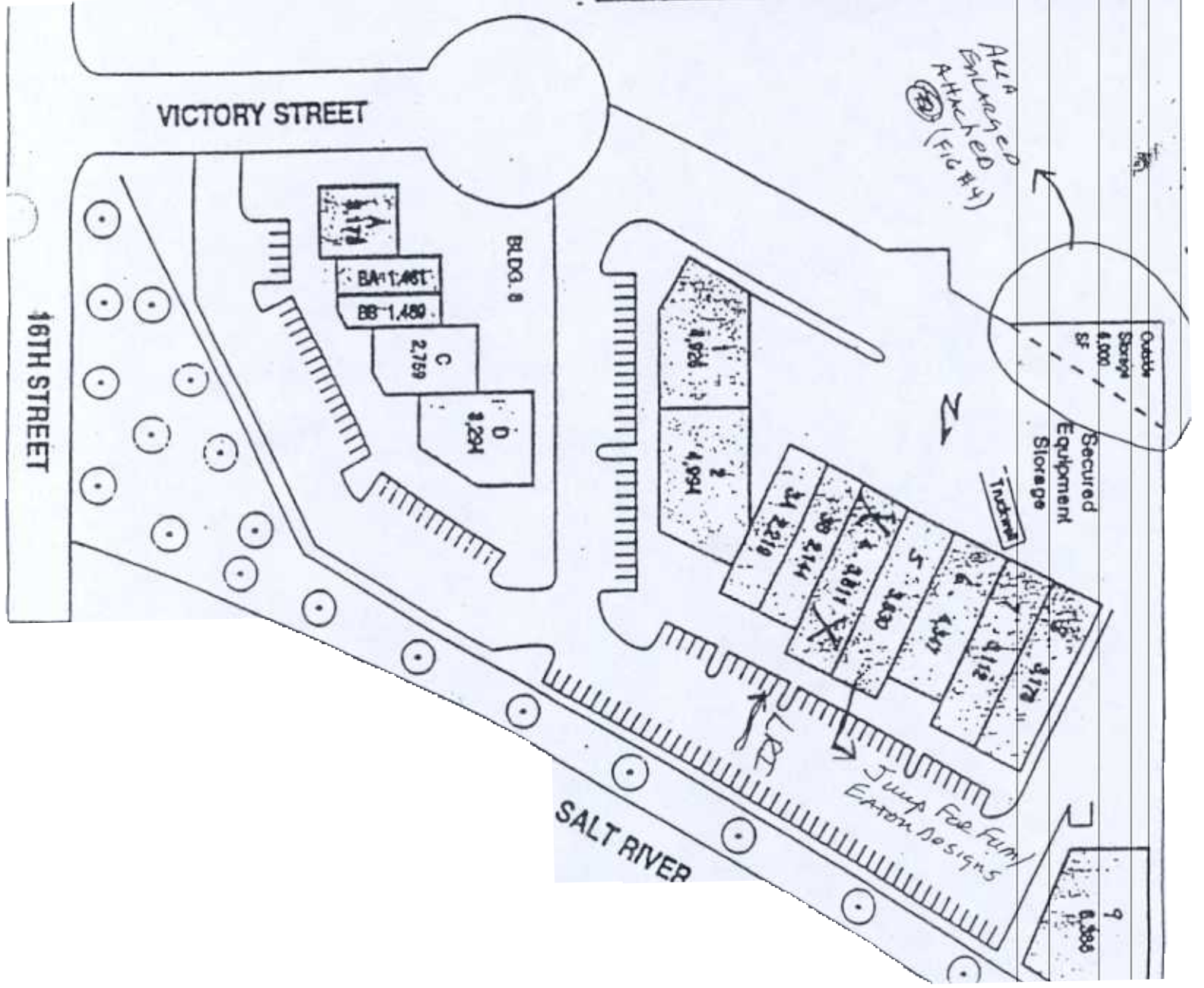

Figure 2 Closure Plan  
Scale: 1" = 10'  
Date 7/16/01

File: Operational Areas  
Lighting Resources Inc.  
Drawn by R. Mann

Storage for 70 Ballast Drums (double stacked)

### Notes

- 14. Vise Table
- 15. Core Dump Table
- \* Empty containers and non-regulated materials stored where room is available
- \* Air-compressors, air tools, bandsaw, and other small tools not specified in print
- \* Metal storage in roll-offs outside as Specified in Quality Assurance Policy

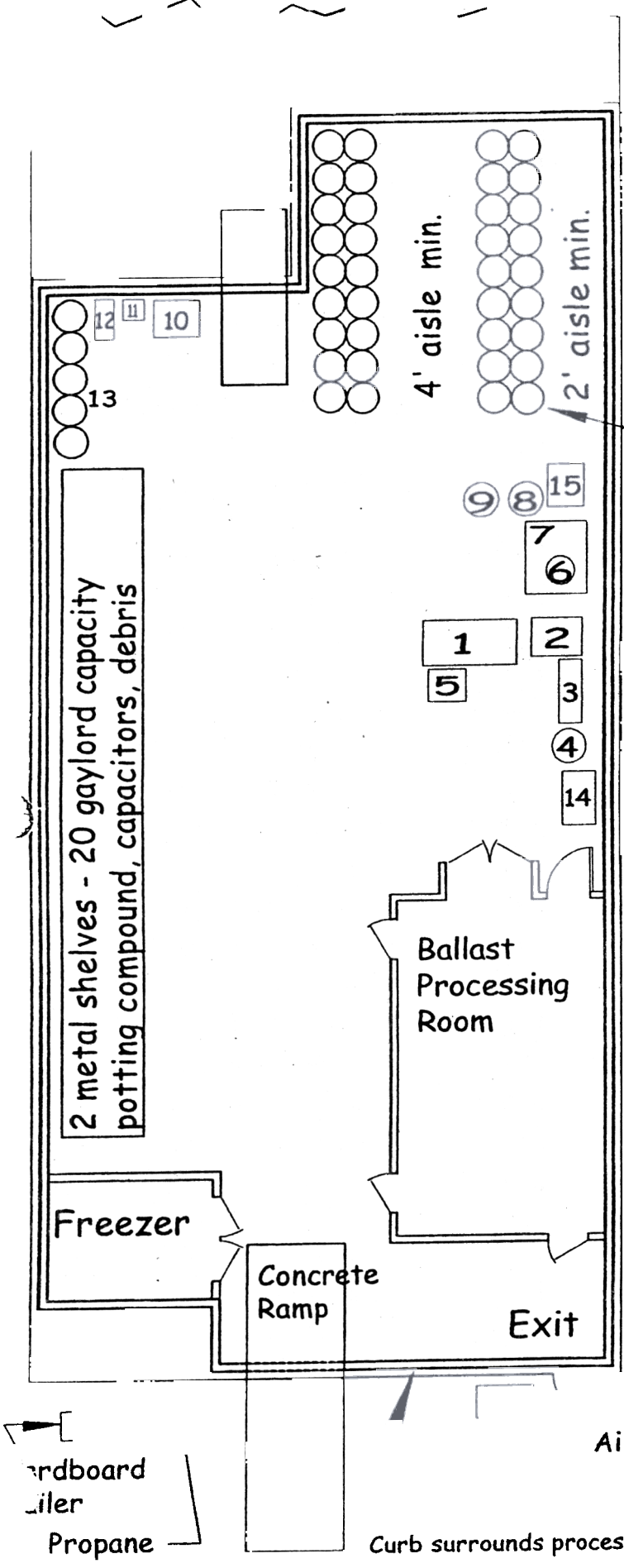

Aircompressor

Cardboard  
Pallet  
Propane

Curb surrounds processing and storage area