



AECOM
100 S. Wacker Drive, Suite 500
Chicago, Illinois 60606

312-939-1000 tel
312-939-4198 fax

May 6, 2016

Ms. Michele Pisterzi
AT&T Illinois
2427 Union Street
Blue Island, Illinois 60406

RE: Radiological Survey of Right-of-Way Utility Excavation
Permit No.: DOT578381
Permit Address: 330-34 E. Ontario St.
AECOM Project No. 60163572

Dear Ms. Pisterzi:

Pursuant to conditions specified in a permit (attached) issued by the City of Chicago, radiation monitoring was required to be performed at the above referenced site. AECOM Technical Services, Inc. (AECOM) provided the required radiation monitoring on April 15, 18, and 25, 2016 for a trench excavations to address an installation of a communication line conduit.

Surveying was conducted in 18-inch lifts for fill soil removed from an irregularly shaped excavation ranging in size from 2 to 8-feet wide, 10 to 18-feet long and to a depth of 3 to 8-feet below ground surface (bgs) in the Right of Way (ROW), as well as private property, at the above referenced address (see sketch). The U.S. Environmental Protection Agency (USEPA) removal action level for Chicago's Streeterville area is 7.1 picocuries per gram (pCi/g) total radium (Ra-226 + Ra-228). The monitoring revealed no indication of soil above the removal action level established by the USEPA for the Streeterville area of Chicago.

Gamma radiation count measurements for the project were made using two different Ludlum Model 2221 survey meters and an unshielded 2 x 2 inch sodium iodide (NaI) probe Model 44-10. For the instrument used, the gamma count indicative of the USEPA 7.1 pCi/g removal action level was 18,278 counts per minute (cpm) unshielded. The field instrument gamma background for the area was measured at approximately 6,600 cpm unshielded. Although none were observed for this project, field gamma measurements greater than twice the field background represent potential anomalous results that require more cautious and frequent field screening, but are not necessarily indications of the presence of thorium contaminated fill soil.

The field gamma measurements within the excavations and of the spoil materials generated during the excavation process did not exceed the field instrument threshold equivalent to the USEPA removal action level and ranged from a minimum of 5,700 cpm to a maximum of approximately 13,100 cpm unshielded. Thus, there was no indication of the presence of radiologically-contaminated fill soil and/or an exceedance of the USEPA removal action level of 7.1 pCi/g total radium.

As part of the permit conditions this letter has been forwarded to:

Chicago Department of Public Health
Attn: Ms. Rahmat Begum
333 South State Street, Rm. 200
Chicago, Illinois 60604

Permit No.: DOT578381
Permit Address: 330-34 E. Ontario St.
Page 2

Please contact us with any questions you have regarding this letter or the reported results.

Regards,



Andrew Kozak
Geologist



Steven C. Kornder, Ph.D.
Senior Project Geoscientist

cc: Rahmat Begum, Chicago Department of Public Health
Verneta Simon, USEPA

Attachments: CDOT Permit
Sketch

PERMIT

Permit # DOT578381

**DOT Public Way Opening
Opening in the Public Way**



City of Chicago
Department of Transportation
(312) 744-4652

Received Date: January 13, 2016 5:05 pm

**A0067E4
ISSUED**

AT&T (SBC IL)
2427 UNION
BLUE ISLAND, IL 60406

MICHELE PISTERZI (708)824-2817

PERMIT DATES

January 05, 2016 through April 22, 2016

PERMIT DETAILS

Public Way Opening for the purpose: TO PLACE FACILITIES FOR CUSTOMER

Excavation may commence on January 05, 2016 - NO SOONER

330 - 334 E ONTARIO ST - Number of Openings: 1

Curb Lane and Traffic Lane

50 Ft (L) x 2 Ft (W) x 3 Ft (D)

Dig Ticket Details:

Dig Ticket Number	Dig Date	Address
600069430	04/08/2016 08:00	330 E - 334 E ONTARIO ST
600069431	04/08/2016 08:00	331 E - 333 E ONTARIO ST

Subcontractors:

DANIEL R. SCHMOLDT ENTERPRISES, INC. (D.R.S. ENTER)
570 COUNTRY LINE ROAD
BENSENVILLE, IL 60106
(216)581-7771

Restrictions:

1. If Arterial Street Outside CBD, Then Start no earlier then 9:00 A.M. and end no later then 4:00 P.M.
2. Contractor must notify DIGGER at 312-744-7000 no less then 48 hours (exclusive of Saturdays, Sundays and Holidays) but no more then 14 calendar days in advance of the start of the excavation or demolition, unless the excavation date was provided with the application and remains unchanged. Prior to 26 calendar days the Contractor must notify DIGGER to renewal the dig date! It is the Excavator's responsibility to request refreshing of marks when needed, but no longer than 28 calendar days after the last requested date. When applicable, all excavation areas are to be clearly marked in safety white paint prior to calling DIGGER. White paint is not required for joint meets or emergency work. Excavators requesting dig tickets are responsible for the protection of utility markings at the job site. Any markings of underground utilities utilizing utility colors must be done by facility owners or authorized agents only.
3. A copy of the permit must remain on-site for inspector's review.
4. If Non-Arterial Street Outside CBD, Then Start no earlier then 7:00 A.M. and end no later then 3:00 P.M.
5. Permittee must provide a sign which identifies the telephone number and company or person performing the work. Signage may be affixed to barricades.
6. Contractor must secure plating over all openings in the roadway and secure all sidewalk/parkway openings during non-working hours until such time when the road surface is restored.
7. No work in or use of the public right of way is to be done when a special event is taking place. It is up to the applicant to determine if an event is scheduled. To obtain a listing of programs or events within the City of Chicago please dial 311 when you are within the City boundaries.

Fees:

01/19/2016 DOT_PWO - Degradation Fee

CAPS:		BB96
Amount:	\$	2,500.00

Total Fees: \$2,500.00

EFFECTIVE DATES OF PERMIT

Current: January 05, 2016 through April 22, 2016 (Input date: January 13, 2016 5:05 pm)

END OF PERMIT

SKETCH

Equipment

Ludlum 2221 S/N: 176944
 Probe 2x2 NaI S/N: RN21192
 unshielded: 18,278
 shielded: 6,123
 background: 6,600
 personnel: Adam Locke, Kyle Kowczak

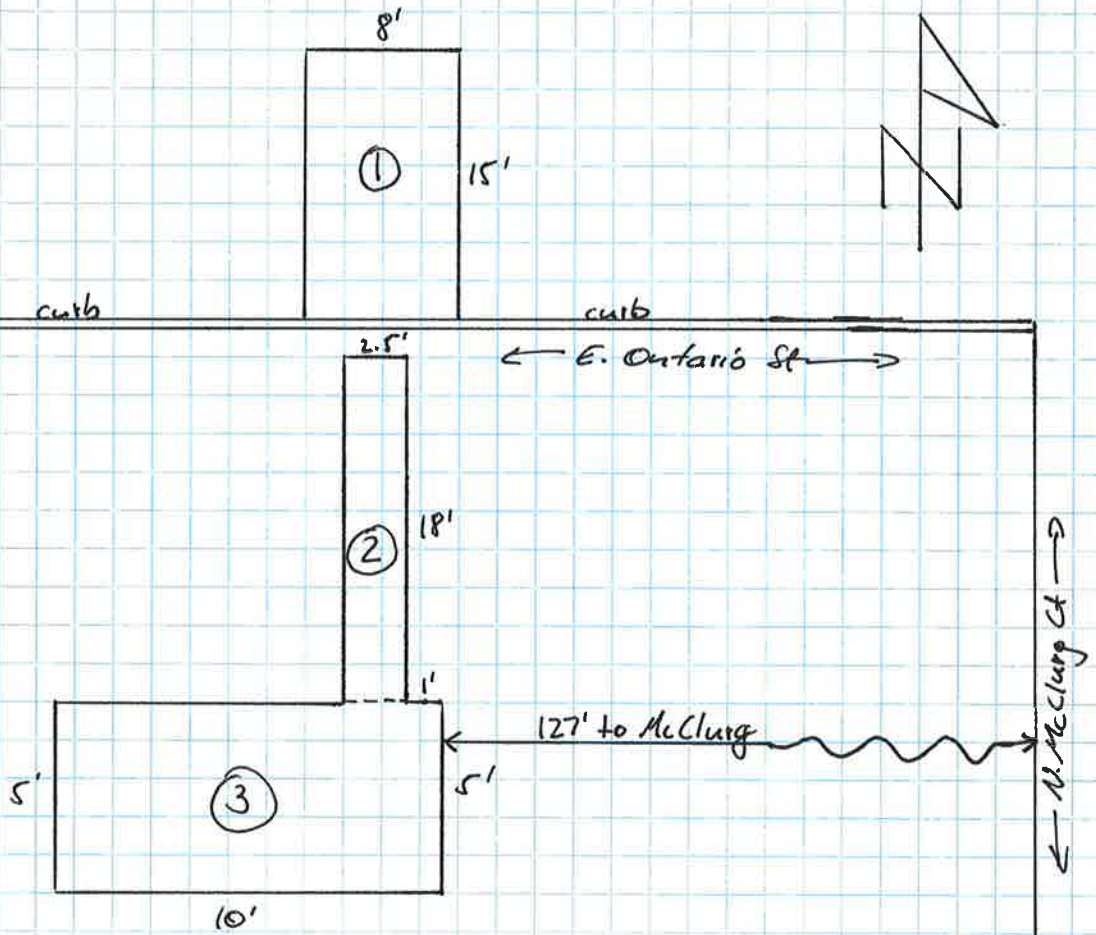

Readings

①	CPM	②	CPM	③	CPM
Depth		Depth		Depth	
0" (surface)	7,400 - 9,200	0" (asphalt)	—	0" (asphalt)	—
18"	8,000 - 12,000	18" (CA-6)	—	15" (CA-6)	45,700
3'-5" (spoil)	6,000 - 10,600	20" (fill)	<7,600	30" (CA-6)	47,100
5'-8" (spoil)	5,800 - 9,300	40" (fill)	<13,600	36" (fill)	47,000
		50" (fill)	<10,900		