



March 1, 2016

Rick McCarthy
James McHugh Construction Co.
1737 S. Michigan Avenue
Chicago, IL 60616

RE: Lakeshore East – Wanda Vista Field Drive Excavation Thorium Monitoring

Dear Mr. McCarthy:

Stan A. Huber Consultants, Inc. (SAHCI) was hired by your firm to provide radiation monitoring during utility location excavations at the Lakeshore East Development (Wanda Vista Field Drive Project) in Chicago, Illinois. The monitoring was performed on February 16, 2016 – February 24, 2016.

Instrumentation

Surface gamma scans were performed by Brian Schmidt using a Ludlum Model 2221 Scaled / Ratemeter (serial no. 126496) with attached 2"x2" NaI probe with 6" lead shield. The instrument was calibrated on October 15, 2015. The USEPA action level of 7.1 picocuries per gram (pCi/g) total thorium for this instrument is 7,054 counts per minute (cpm).

The average background count rate for this location was found to be 3,317 cpm.

Soil Gamma Scans

Gamma surface scans were performed using the Ludlum Model 2221 Scaler / Ratemeter described above. Data was collected by entering the excavation after each 18 inch lift and recording the highest count rate for the floors and walls to an excavation depth of 4 feet. Soil removed from depths of 4 feet to 12 feet was surveyed in the excavator bucket as it was removed from the excavation. Soil removed from the excavation was stockpiled onsite.

The maximum gamma count rate for each 1.5 foot lift was recorded on the attached Radiation Survey Forms. The count rates in the excavations ranged from 1,800 cpm to 5,700 cpm. No count rates were found at any time that exceeded the threshold limit of 7,054 cpm.

Additional Monitoring

Since no count rates were identified above the 7.1 pCi/gram threshold limit, no additional soil sampling, air monitoring, or personnel monitoring were performed.

You will need to forward a copy of this report to the City of Chicago Department of Public Health (Attn: Rahmatunsia Begum) with the CDOT Permit Number in the subject line. Additionally, all thorium monitoring data should be retained for review by USEPA.

Thank you for your assistance with this project. If you have any questions or need additional information please call me at (815) 485-6161.

Sincerely,
Stan A. Huber Consultants, Inc.

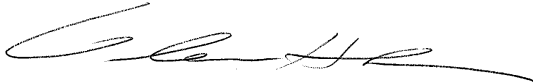
A handwritten signature in black ink, appearing to read 'Glenn Huber', written in a cursive style.

Glenn Huber, CHP
President

Radiation Survey Form

Location/ Project ID: WANDA FIELD DRIVE UTILITY LOCATIONS TRENCH - CHICAGO, IL

Date: 2/16-17/2016

Technician: BRIAN SCHMIDT

Inst Model: LUDUM-2221

Serial No. : 126496

Probe Type: 1"x1" NaI / 2"x2" NaI
Shielded / Not Shielded

Lift Elevation: 0 - 144"

Background 3317 cpm

Action Level: 7054 cpm

Write grid designations in circles. Record highest counts for grid in cpm. Record 30 second counts at grid intersections (if required). Shade areas of elevated counts and record max cpm.

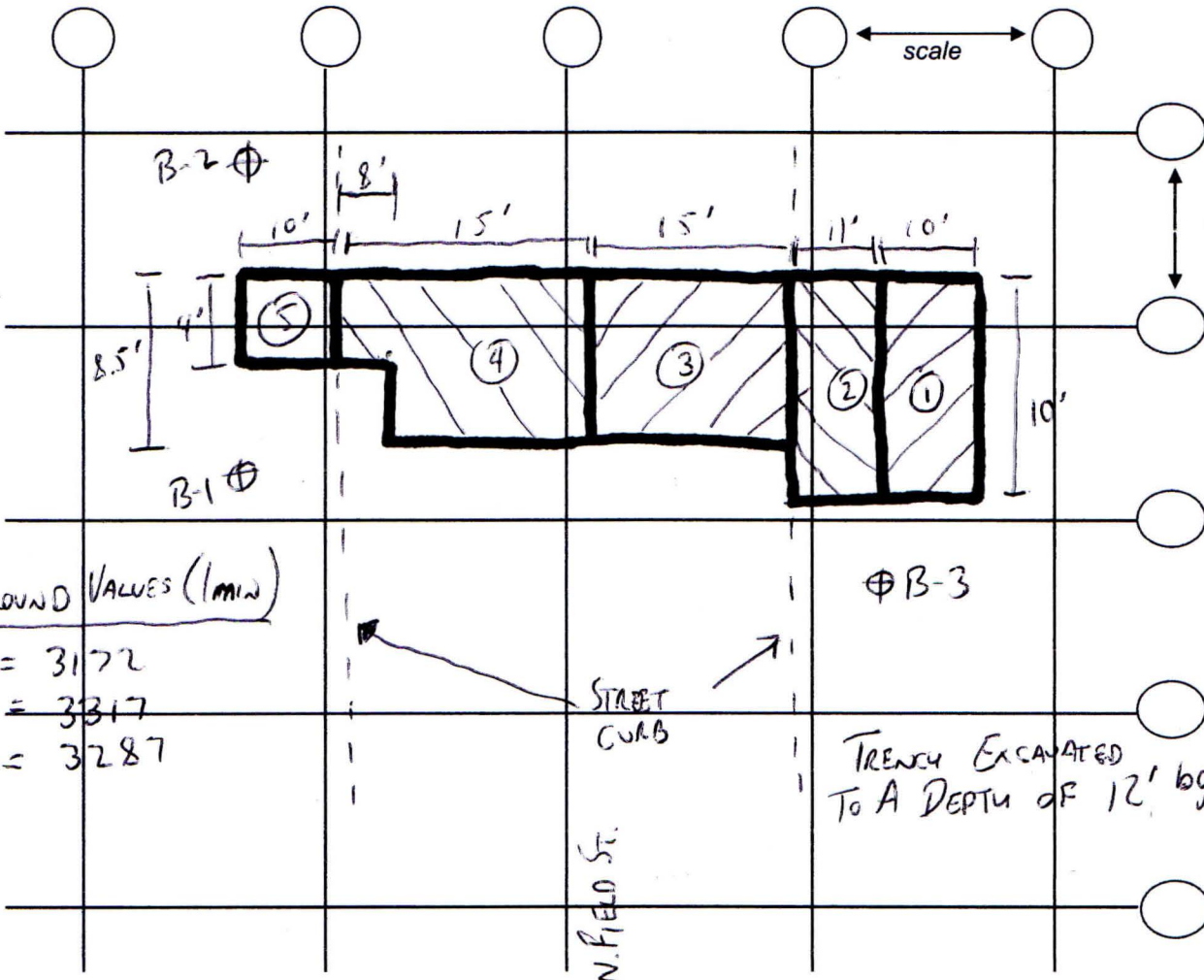

BACKGROUND VALUES (1min)

B-1 = 3172
 B-2 = 3317
 B-3 = 3287

Radiation Survey Form

Location/ Project ID: WANDA FIELD DRIVE UTILITY LOCATION TRENCH - CHICAGO, IL

Date: 2/16-17/2016

Technician: BRIAN SCUNIOR

Inst Model: LUCKY-2221

Serial No. : 126496

Probe Type: 1"x1" NaI / 2"x2" NaI
Shielded / Not Shielded

Lift Elevation: 0-144"

Background 3317 cpm

Action Level: 7054 cpm

Write grid designations in circles. Record highest counts for grid in cpm. Record 30 second counts at grid intersections (if required). Shade areas of elevated counts and record max cpm.

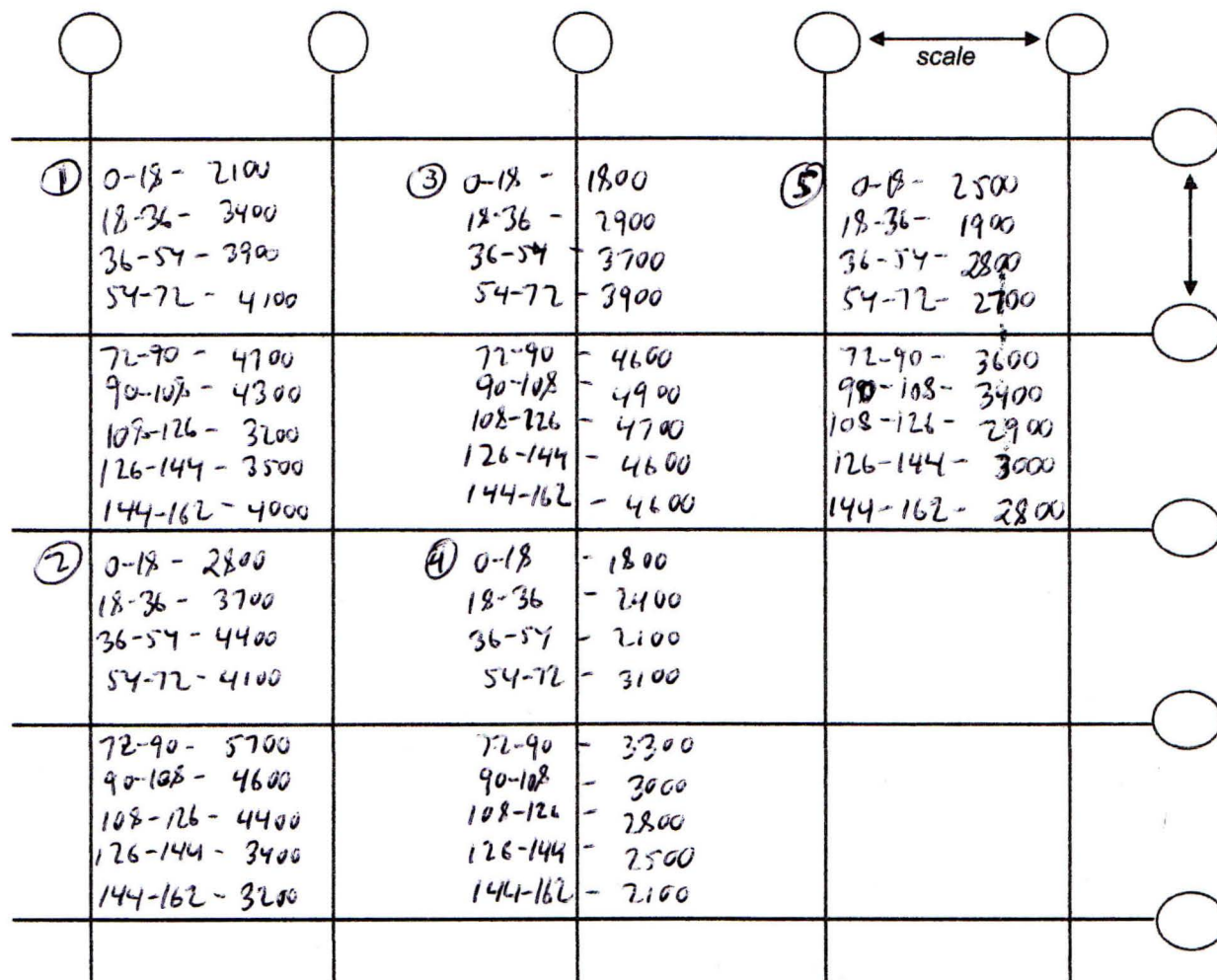

Radiation Survey Form

Location/ Project ID: WANDA FIELD DRIVE UTILITY LOCATION TRENCH - CHICAGO, IL

Date: 2/23-24/2016

Technician: BRIAN SCHMIDT

Inst Model: LUDLUM-2221

Serial No.: 126496

Probe Type: 1"x1" NaI / 2"x2" NaI
Shielded / Not Shielded

Lift Elevation: 0-144"

Background 3317 cpm

Action Level: 7054 cpm

Write grid designations in circles. Record highest counts for grid in cpm. Record 30 second counts at grid intersections (if required). Shade areas of elevated counts and record max cpm.

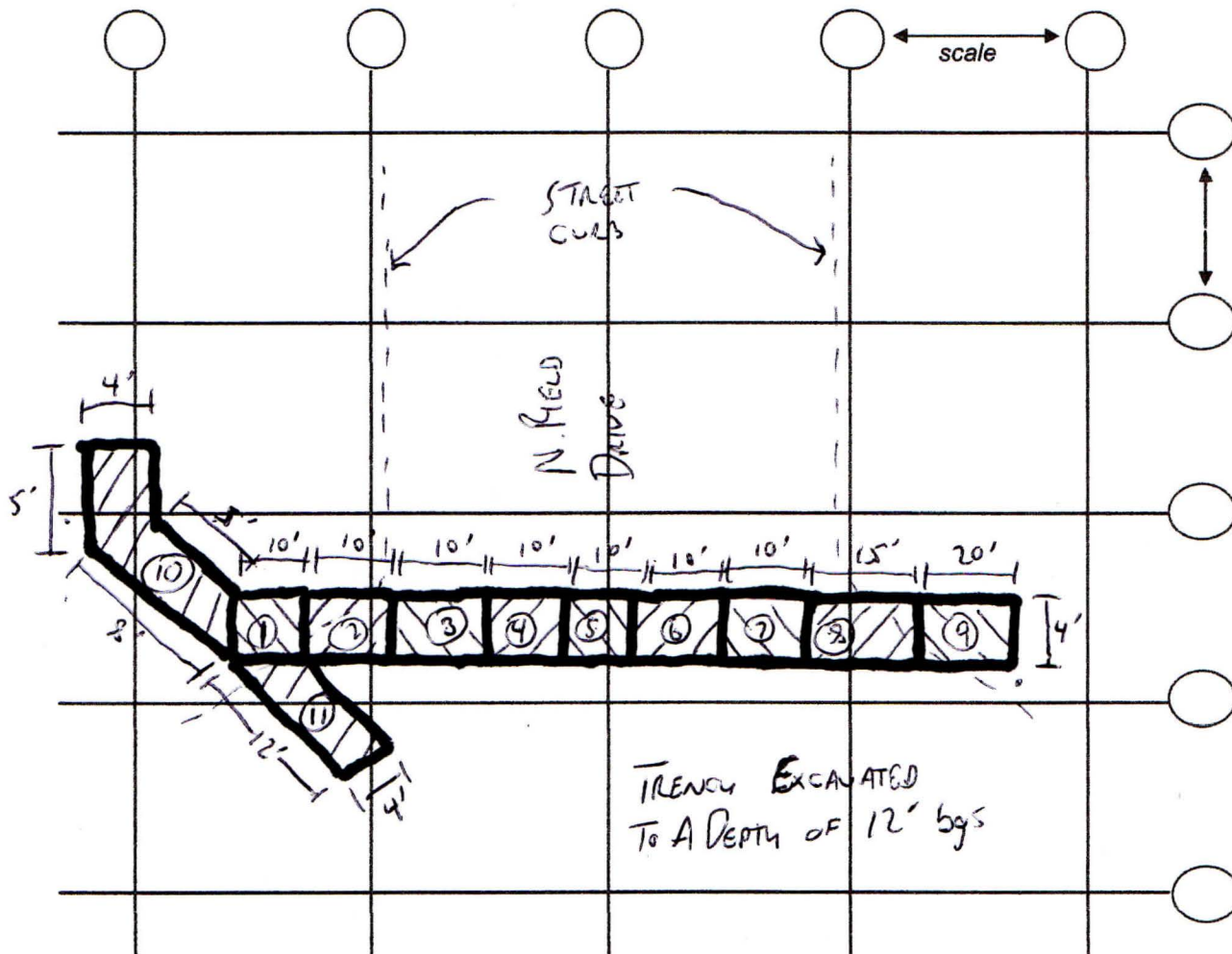

Radiation Survey Form

Location/ Project ID: WANDA KIELO DRIVE UTILITY LOCATION TRENCH - CHICAGO, IL

Date: 2/23-24/2016 Technician: Brian Schmitt

Inst Model: LS6001M-2221 Serial No.: 126496

Probe Type: 1"x1" NaI / 2"x2" NaI Lift Elevation: 0-144"
Shielded / Not Shielded

Background 3317 cpm Action Level: 7054 cpm

Write grid designations in circles. Record highest counts for grid in cpm. Record 30 second counts at grid intersections (if required). Shade areas of elevated counts and record max cpm.

