



AECOM  
303 E. Wacker Drive, Suite 900  
Chicago, Illinois 60601

312-938-0300 tel  
312-938-1109 fax

April 23, 2012

Ms. Michele Pisterzi  
AT&T Illinois  
2427 Union Street  
Blue Island, Illinois 60406

RE: Radiological Survey of Right-of-Way Utility Excavation  
Permit No.: 258158611  
Permit Address: 479 N Columbus Drive  
AECOM Project No. 60163572

Dear Ms. Pisterzi:

Pursuant to conditions specified in a permit (see attached) issued by the City of Chicago, radiation monitoring was required to be performed at the above referenced site. AECOM Technical Services, Inc. (AECOM) provided the required radiation monitoring on April 13-17, 2012 for a trench excavation to install a telephone communications service package.

Surveying was conducted in 18-inch lifts for soils removed from an approximately 5-foot square area around an existing light pole foundation down to 11-feet and an approximately 2-foot wide by 109-foot long trench excavation including an elbow at 46-feet from the pole excavation to a depth of 36-inches in the Right of Way (see sketch), required for the installation of a telephone communications service package. The monitoring revealed no indication of soils above the specified clean-up value established by the U.S. Environmental Protection Agency (USEPA) for the Streeterville area of Chicago. The USEPA value for Chicago's Streeterville area is 7.1 picocuries per gram (pCi/g total radium (Ra-226 + Ra-228)).

Gamma radiation count measurements for the project were made using a Ludlum Model 2221 survey meter and an unshielded 2 x 2 NaI probe (Model 44-10). For the instrument used, the gamma count threshold equivalent to the 7.1 pCi/g threshold was 20,356 counts per minute (cpm) unshielded (7,567 cpm shielded). The field gamma background for the area was measured at approximately 4,700 cpm unshielded. The field gamma measurements within the excavation and of the spoil materials generated during the excavation process did not exceed the respective field instrument threshold values previously stated and ranged from a minimum of 4,500 cpm unshielded to a maximum of 5,700 cpm shielded in the bottom of the excavation. Thus, there was no indication of the presence of radiologically-contaminated soil and/or an exceedance of the USEPA cleanup value of 7.1 pCi/g total radium.

As part of the permit conditions this letter has been forwarded to:

Chicago Department of Public Health  
Attention: Ms. Rahmat Begum  
333 South State Street, Rm. 200  
Chicago, Illinois 60604

Radiological Survey of Right-of-Way Utility Excavation  
Permit No.: 258158611  
Page 2

Please contact us with any questions you have regarding this letter or the reported results.

Regards,



Joshua J. Rowe  
Project Scientist II



Steven C. Kornder, Ph.D.  
Senior Project Geoscientist

cc: Rahmat Begum, Chicago Department of Environment  
Verneta Simon, USEPA

Attachments: Permit  
Sketch



DEPARTMENT OF PUBLIC HEALTH  
CITY OF CHICAGO

FORM NO. CDPH.ROW.03

Notice is hereby given that the site you have requested a permit for is recorded with the City of Chicago Department of Public Health (CDPH) as potentially having environmental contamination on the site and adjacent right-of way. This environmental contamination could present a threat to human health and safety in connection with work performed at the site, or in the adjacent right-of-way, if proper safeguards are not employed.

A file containing detailed information regarding the aforementioned environmental contamination is available for review at CDPH at 33 N. LaSalle St., Suite LL-120, Chicago, Illinois 60602 during normal business hours (8:30AM-4:30PM, Monday through Friday). Contact (312) 744-3152 for an appointment. This file must be reviewed and the remainder of this form completed before the permit can be issued if the ground is exposed or excavated. **Please note that for some locations, additional health and safety procedures may be required by law.**

Please complete the following:

I have reviewed and understand the documents, maintained by CDPH, regarding environmental contamination of the site and adjacent right-of-way. Further, I will ensure that all work at the subject site and adjacent right-of-way, and any monitoring required including but not limited to radiation monitoring, will be performed in a manner that is protective of human health and the environment and in compliance with all applicable local, state, and federal laws, rules, and regulations, especially those pertaining to worker safety and waste management. I will ensure that the results of any radiation monitoring and/or surveying conducted shall be provided to the CDPH and the United States Environmental Protection Agency **within two (2) weeks of their completion.** If any elevated levels of radioactive material are detected, I will immediately contact the United States Environmental Protection Agency at (800) 424-8802.

Applicant Name (print): Gia McElligott Signature: Gia McElligott

Site Address and Work Location (Describe exact site location and attach map): 3179-501 N. Columbus Dr - Trench

2-60'x2x3 in curb/trench - Dig 1-6x6x11-in sidewalk/@ 300-306 E Illinois - Trench approx

Nature of Work: 65'x2x3-in Curb In. Trench Dig - To Remove/Replace Pole in Sidewalk - Place IP  
& Cable

Company Name, Address, Phone No.: At&T 225 W Randolph Chicago

General / Prime Contractor Name, Address, Phone No.: John Buens Const / Cobra / Hydeo Exc  
*Include subcontractor information if applicable*

Safety Officer / Phone No. Steve Kosmbe - 847-279-2448

Radiation Contractor / Phone No. (if applicable) AECOM - Steve Kosmbe - 847-279-2448

Check if City Department Work  Department Name: \_\_\_\_\_

CDOT Permit No.: 258158611

Today's Date: 3-28-12 Expected Start Date: \_\_\_\_\_ CDPH Approval / Date: Rahmetunisa Begum  
3/29/2012

Please return this completed form to the Chicago Department of Transportation, Division of Infrastructure Management, Public Way Permit Office, City Hall - Room 905, 121 N. LaSalle St., Chicago, Illinois 60602 during normal business hours (8:30 AM - 4:30 PM, Monday through Friday)

For CDPH Use Only



PROJECT	AT&T 479 N Columbus Dr		STS JOB NO.
SUBJECT	Report Sketch		CALC. NO.
DATE	4/20/12	BY Josh Rowe	CHECKED BY
			REV. NO.



Illinois

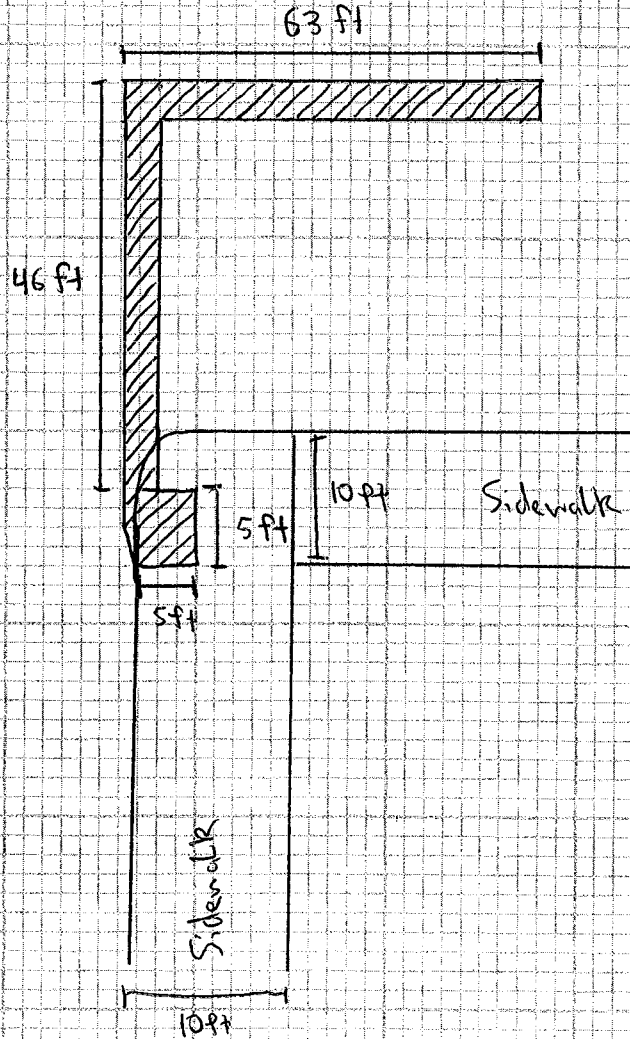

Depth	Counts per Minute
0-12"	concrete
12-24"	7,700 unshielded
24-36"	5,700 shielded

not to scale

Columbus

Sidewalk

Sidewalk