

**AECOM**  
303 East Wacker Drive, Suite 900  
Chicago, Illinois 60601

312.938.0300 tel  
312.938.1109 fax

October 15, 2010

Mr. Narendra Prasad  
Integrays Business Support, LLC  
Environmental Services Department  
130 East Randolph, 22nd Floor  
Chicago, IL 60601

**Subject: Radiological Survey of Right-of-Way Utility Excavation**  
**Permit No.: 775897029**  
**Permit Address: 170-171 North Field Boulevard**  
**AECOM Project No 60157647**

Dear Mr. Prasad:

Radiation monitoring was performed at the above referenced site pursuant to conditions specified in the permit (Attachment A) issued by the City of Chicago Department of Environment (CDOE). AECOM provided the required radiation surveillance on October 1 and 4, 2010 for the excavation of a 3-foot wide and 50-foot long service trench in the vicinity of the permitted address (refer to Attachment B). A survey of the proposed trench area was conducted prior to the removal of pavement. After removal of the pavement, AECOM proceeded to monitor the soils in 18-inch thick horizontal lifts. Trench depth was approximately 3 to 4-feet except at the eastern end where a 10-foot section was excavated to a depth of 8-10 feet.

The monitoring revealed no indication of soils above the specified clean-up threshold established by the United States Environmental Protection Agency (USEPA) for the Streeterville area of Chicago. The USEPA threshold for Chicago's Streeterville area is 7.1 picocuries per gram (pCi/g total radium (Ra-226 + Ra-228). Gamma radiation count measurements for the project were made using Ludlum Model 2221 survey meter and an unshielded 2 x 2 NaI probe (Model 44-10). For the instrument used, the gamma count indicative of the 7.1 pCi/g total radium threshold was 17,522 counts per minute (cpm). Field gamma measurements within the excavation and of the spoil materials ranged from a minimum of 5,000 cpm to a maximum of 10,000 cpm. Thus, there was no indication of an exceedance of the USEPA cleanup threshold.

Finally, as part of the permit conditions, this letter has been forwarded to:

Chicago Department of Environment  
Attention: Ms. Rahmat Begum  
30 North LaSalle Street, 2<sup>nd</sup> Floor  
Chicago, Illinois 60602

Please contact us with any questions you have regarding this letter or the reported results.

Regards,

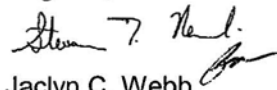
  
Jaclyn C. Webb

Staff Engineer

cc: Rahmat Begum, Chicago Department of Environment  
Verneta Simon, USEPA

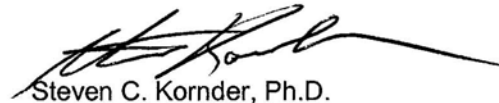
  
Steven C. Kornder, Ph.D.  
Senior Project Geochemist

Attachment A Permit  
Attachment B Excavation Location

**Attachment A**

**Permit**

**Permit # 775897029**

Received Date: Sep 15, 2010 8:48:152

**PEOPLES GAS LIGHT & COKE CO**  
**130 EAST RANDOLPH**  
**DRIVE**  
**CHICAGO, IL 60601**



**City of Chicago**  
**Department of Transportation**  
**(312) 744-4652**

**KANE 773-542-7830**

**ACTIVITY HOURS**

See **RESTRICTIONS** for permitted hours

**DATES**

**Sep 15, 2010 through Oct 15, 2010**

**ACTIVITIES**

**Street Opening (Curb Lane, Parkway, Sidewalk):**

**Dig #: TBD**

There will be 1 opening(s) in the public way for the purpose: **NEW SERVICE INSTALLATION.**

**40 Feet x 3 Feet x 5 Feet**

Excavation may commence on - **NO SOONER.**

**170- 171 N FIELD BV**

**HORIZONTAL DIRECTIONAL DRILLING**  
**WORK TO BE PERFORMED BY: NPL**

**OK TO RELEASE, PER RAHMAT BEGUM ON 9/24/10**

**Restrictions:**

1. A copy of the permit must remain on-site for inspector's review.
2. Permit fees must be paid within 24 hours of the date of issuance. Failure to pay will result in you being considered in violation of the terms and agreement of the permit and subject to any applicable fine and fees as if you have not attained a permit. Additionally, you will still be

**Restrictions:**

- responsible for the cost of the original permit. Monthly billing accounts are not applicable to the 24 hour payment criteria but failure to pay the monthly bill by the due date will result in the same penalties applying.
3. All directional boring must be pre-approved by the Office of Underground Coordination.
  4. Contractor must secure plating over all openings in the roadway during non-working hours until such time when the road surface is restored.
  5. All traffic control will be the responsibility of the contractor and must comply with all MUTCD standards.
  6. Restore all lanes to normal operation during non-working hours.
  7. Must use flagmen and/or arrow boards to maintain traffic operations through the work zone.
  8. Contractor must notify DIGGER at 312-744-7000 no less than 48 hours (exclusive of Saturdays, Sundays and Holidays) but no more than 14 calendar days in advance of the start of the excavation or demolition, unless the excavation date was provided with the application and remains unchanged. Prior to 26 calendar days the Contractor must notify DIGGER to renew the dig date!
  9. It is the Excavator's responsibility to request refreshing of marks when needed, but no longer than 28 calendar days after the last requested date.
  10. When applicable, all excavation areas are to be clearly marked in safety white paint prior to calling DIGGER. White paint is not required for joint meets or emergency work.
  11. Excavators requesting dig tickets are responsible for the protection of utility markings at the job site. Any markings of underground utilities utilizing utility colors, must be done by facility owners or authorized agents only.
  12. Permittee must provide a sign which identifies the telephone number and company or person performing the work. Signage may be affixed to barricades.
  13. Permanent base pavement restoration to follow within 5 days after the completion of underground work.
  14. All pavements are to be restored in accordance with CDOT Construction Standards.
  15. All street openings must be restored with concrete base to grade.
  16. Work to be performed as per plans and specifications.
  17. Use of pneumatic equipment must not begin before 8:00 A.M. or continue after 8:00 P.M.
  18. Maintain pedestrian and vehicular traffic at all times.
  19. Pavement opening to be backfilled to grade or plated during off work hours.
  20. Parkway excavation by hand, cut and replace sod wherever possible.
  21. Permittee to provide all barricades, signs and/or flagmen as necessary.
  22. ~~Sidewalk pavement broken by hand or with pneumatic hammer only.~~
  23. **WARNING: THIS WORKSITE(S) CONTAINS PETROLEUM MATERIAL. ANY QUESTIONS PERTAINING TO HANDLING OF MATERIALS, CONTACT THE DEPT. OF ENVIRONMENT AT 312-744-3152.**
  24. Contractors to post signs to indicate: **BIKE LANE CLOSED - SHARED LANE YIELD TO BIKES.**

**Restrictions:**

- It is also the permit holder's responsibility to restore to original condition any damage to any bikeway, including replacement pavement markings and signage. You must contact Ben Gomberg (312) 744-8093 48 hours in advance of any activity.
- 25. No work in or use of the public right of way is to be done when a special event is taking place. It is up to the applicant to determine if an event is scheduled. To obtain a listing of programs or events within the City of Chicago please dial 311 when you are within the City boundaries.
- 26. It is the responsibility of the applicant to fund Traffic Control Aides if the City deems it necessary due to heavy congestion situations.
- 27. Pursuit to City Ordinances 10-20-150 and 10-28-281.3 a re-inspection fee of \$100 may be assessed for each inspection conducted after the initial inspection.
- 28. All metal plates used for public way construction or placed within the right-of-way must indicate Ownership!

Grand Total Fees: \$ 354.00

Affected CUAN Sites: 7, 15, 20, 21, 22, 24, 28, 29, 31, 34, 38, 53, 61, 68, 70, 86, 141, 147

**EFFECTIVE DATES OF PERMIT**  
 Current: Sep 15, 2010 through Oct 15, 2010 ( Input date: Sep 15, 2010 8:48:52 a.m. )

**END OF PERMIT**

| PEOPLES GAS LIGHT & COKE CO | Permit # 775897029 | Counter | Page #/ 3 |
|-----------------------------|--------------------|---------|-----------|
| 5182786192                  |                    |         |           |

**Attachment B**

**Excavation Location**

**AECOM**

|         |         |                             |     |            |          |
|---------|---------|-----------------------------|-----|------------|----------|
| PROJECT |         | Radiological Screening Loc. |     | JOB NO.    | 60157647 |
| SUBJECT |         | 170-171 N. Field Dr.        |     | CALC. NO.  | 1        |
| DATE    | 10/1/10 | BY                          | SCR | CHECKED BY | STN      |
|         |         |                             |     | REV. NO.   | 0        |

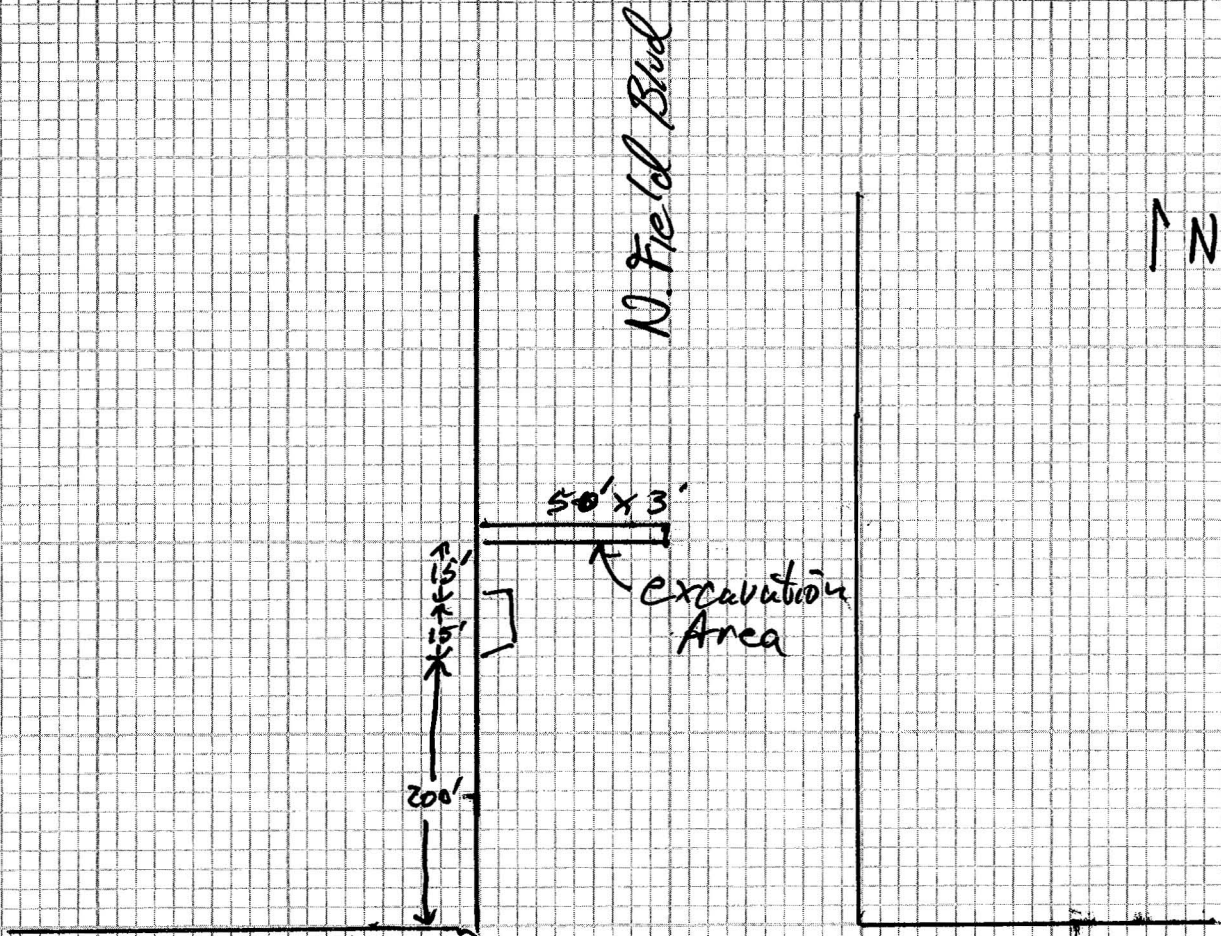

Lower to Randolph

Not to Scale