



AECOM
303 E. Wacker Drive, Suite 900
Chicago, Illinois 60601

312-938-0300 tel
312-938-1109 fax

August 5, 2014

Mr. Mike Jouras
People's Gas Light & Coke Co.
Environmental Services Department
200 E. Randolph Street, 24th Floor
Chicago, IL 60601

RE: Radiological Survey of Right-of-Way Utility Excavation
Permit No.: 468983145
Permit Address: 639-640 East Ohio Street
AECOM Project No. 60157647

Dear Mr. Jouras:

Pursuant to conditions specified in a permit (see attached) issued by the City of Chicago, radiation monitoring was required to be performed at the above referenced site. AECOM Technical Services, Inc. (AECOM) provided the required radiation surveillance between the days of July 29-31, 2014 for an excavation to replace an existing gas main for an address located between 639-640 E. Ohio St.

Surveying was performed for the soil removed from a 7-foot by 22-foot trench excavation within a sidewalk located adjacent to a CTA bus turnaround street located northwest of Navy Pier (see sketch). Excavation to a depth of 4-feet below ground surface was required for the replacement of an existing gas main. The monitoring revealed no indication of soils above the specified clean-up value established by the U. S. Environmental Protection Agency (USEPA) for the Streeterville area of Chicago. The USEPA cleanup value for Chicago's Streeterville area is 7.1 picocuries per gram (pCi/g) total radium (Ra-226 + Ra-228).

Gamma radiation count measurements for the project were made using Ludlum Model 2221 survey meter and an unshielded 2 x 2 inch NaI probe (Model 44-10). For the instrument used, the gamma count threshold indicative of the 7.1 pCi/g cleanup value is 17,390 counts per minute (cpm) unshielded (5,799 cpm shielded). The field gamma background for the area was measured at approximately 5,800 cpm unshielded. The field gamma measurements within the excavation and of the spoil materials generated during the excavation process did not exceed the instrument threshold previously stated and ranged from a minimum of 5,100 cpm to a maximum of 6,700 cpm unshielded. Thus, there was no indication of the presence of radiologically-contaminated material and/or an exceedance of the USEPA cleanup value of 7.1 pCi/g total radium.

As part of the permit conditions this letter has been forwarded to:

Chicago Department of Public Health
Attention: Ms. Rahmat Begum
333 South State Street, Room 200
Chicago, Illinois 60604

Please contact us with any questions you have regarding this letter or the reported results.

Regards,



Brian R. Schmidt
Project Scientist II



Steven C. Kornder, Ph.D.
Senior Project Geoscientist

cc: Rahmat Begum, Chicago Department of Public Health
Verneta Simon, USEPA

Attachments: Permit
Sketch

PERMIT



DEPARTMENT OF PUBLIC HEALTH
CITY OF CHICAGO

FORM NO. CDPH.ROW.03 (STREETERVILLE Right-of-Way)

Notice is hereby given that the site you have requested a permit for is recorded with the City of Chicago Department of Public Health (CDPH) as potentially having environmental contamination on the site and adjacent right-of-way. This environmental contamination could present a threat to human health and safety in connection with work performed at the site, or in the adjacent right-of-way, if proper safeguards are not employed.

A file containing detailed information regarding the aforementioned environmental contamination is available for review at CDPH at 333 S. State St., Room 200, Chicago, Illinois 60604 during normal business hours (8:30AM-4:30PM, Monday through Friday). Contact (312) 745-3152 for an appointment. This file must be reviewed and the remainder of this form completed before the permit can be issued if the ground is exposed or excavated. Please note that for some locations, additional health and safety procedures may be required by law.

Please complete the following:

I have reviewed and understand the documents, maintained by CDPH, regarding environmental contamination of the site and adjacent right-of-way. Further, I will ensure that all work at the subject site and adjacent right-of-way, and any monitoring required including but not limited to radiation monitoring, will be performed in a manner that is protective of human health and the environment and in compliance with all applicable local, state, and federal laws, rules, and regulations, especially those pertaining to worker safety and waste management. I will ensure that the results of any radiation monitoring and/or surveying conducted shall be provided to the CDPH and the United States Environmental Protection Agency within two (2) weeks of their completion. If any elevated levels of radioactive material are detected, I will immediately contact the United States Environmental Protection Agency at (800) 424-8802.

Applicant Name (print): Maria Oliver Signature: Maria J. Oliver

Site Address and Work Location (Describe exact site location and attach map):

639-640 E. Ohio St.

Nature of Work: New Service Installation

Company Name, Address, Phone No.: Peoples Gas, 200 E. Randolph (312) 240-4692

General / Prime Contractor Name, Address, Phone No.: Tony Soudonato (773) 542-7909

Include subcontractor information (if applicable)
Safety Officer / Phone No. Jerry Grass (773) 542-7927

Radiation Contractor / Phone No. (if applicable) Steve Koruder - AECOM, Inc. (847) 279-2500

Check if City Department Work Department Name: _____

CDOT Permit No.: 468983145

Today's Date: 7/14/14 Expected Start Date: 7/28/14 CDPH Approval / Date J Sheeran 7-14-14

Please return this completed form to the Chicago Department of Transportation, Division of Infrastructure Management, Public Way Permit Office, City Hall - Room 905, 121 N. LaSalle St., Chicago, Illinois 60602 during normal business hours (8:30 AM - 4:30 PM, Monday through Friday)

For CDPH Use Only

Restrictions:

1. A copy of the permit must remain on-site for inspector's review.
2. Permit fees must be paid within 24 hours of the date of issuance. Failure to pay will result in you being considered in violation of the terms and agreement of the permit and subject to any applicable fine and fees as if you never attained a permit. Additionally, you will still be responsible for the cost of the original permit. Monthly billing accounts are not applicable to the 24 hour payment criteria but failure to pay the monthly bill by the due date will result in the same penalties applying.
3. All directional boring must be pre-approved by the Office of Underground Coordination.
4. Contractor must secure plating over all openings in the roadway and secure all sidewalk/parkway openings during non-working hours until such time when the road surface is restored.
5. Contractor must notify DIGGER at 312-744-7000 no less than 48 hours (exclusive of Saturdays, Sundays and Holidays) but no more than 14 calendar days in advance of the start of the excavation or demolition, unless the excavation date was provided with the application and remains unchanged. Prior to 26 calendar days the Contractor must notify DIGGER to renew the dig date!
6. It is the Excavator's responsibility to request refreshing of marks when needed, but no longer than 28 calendar days after the last requested date.
7. When applicable, all excavation areas are to be clearly marked in safety white paint prior to calling DIGGER. White paint is not required for joint meets or emergency work.
8. Excavators requesting dig tickets are responsible for the protection of utility markings at the job site. Any markings of underground utilities utilizing utility colors, must be done by facility owners or authorized agents only.
9. Permittee must provide a sign which identifies the telephone number and company or person performing the work. Signage may be affixed to barricades.
10. Permanent base pavement restoration to follow within 5 days after the completion of underground work.
11. All pavements and pavement markings are to be restored in accordance with CDOT Construction Standards.
12. Work to be performed as per plans and specifications.
13. Use of pneumatic equipment must not begin before 8:00 A.M. or continue after 8:00 P.M.
14. Maintain pedestrian traffic at all times.
15. Pavement opening to be backfilled to grade/or plated during off work hours.
16. Parkway excavation by hand, cut and replace sod wherever possible.
17. Permittee to provide all barricades, signs and/or flagmen as necessary.
18. Sidewalk pavement broken by hand or with pneumatic hammer only.
19. No work in or use of the public right of way is to be done when a special event is taking place. It is up to the applicant to determine if an event is scheduled. To obtain a listing of programs or events within the City of Chicago please dial 311 when you are within the City boundaries.
20. It is the responsibility of the applicant to fund Traffic Control Aides if the City deems it necessary due to heavy congestion situations.
21. Pursuit to City Ordinances 10-20-150 and 10-28-281.3 a re-inspection fee of \$100 may be

PEOPLES GAS LIGHT & COKE CO

Permit # 284966161

Counter

Page #: 2

5208552739

Restrictions:

assessed for each inspection conducted after the initial inspection.

Sidewalk & Parkway Opening(s)

12-14-2012 - Fee Pavement Opening

CBD:	Y	Cost Per EA:	\$ 391.00	CAPS:	300-84-2135-256
Tiered:	N	# Of EA:	1.00	Late charge:	\$.00
Mora:	N			Amount:	\$ 391.00

Total Fees: \$ 391.00

Grand Total Fees: \$ 391.00

Affected CUAN Sites: 7, 15, 21, 22, 28, 29, 34, 38, 53, 61, 68, 70, 141, 147

EFFECTIVE DATES OF PERMIT
Current: Dec 14, 2012 through Dec 31, 2012 (Input date: Dec 20, 2012 2:48:53 p.m.)
Previous: Dec 14, 2012 through Dec 21, 2012 (Input date: Dec 14, 2012 3:52:48 p.m.)

END OF PERMIT

5208552739



PGL's construction will be carried out in the sidewalk by the CTA bus turn-around.

A 6'*6' opening (green in above picture and approximate location) would be made with the depth being approximately 4'6".

The duration of the work would be 2-3 days.

Henkels and McCoy will be performing work at this location on behalf of PGL.

SKETCH

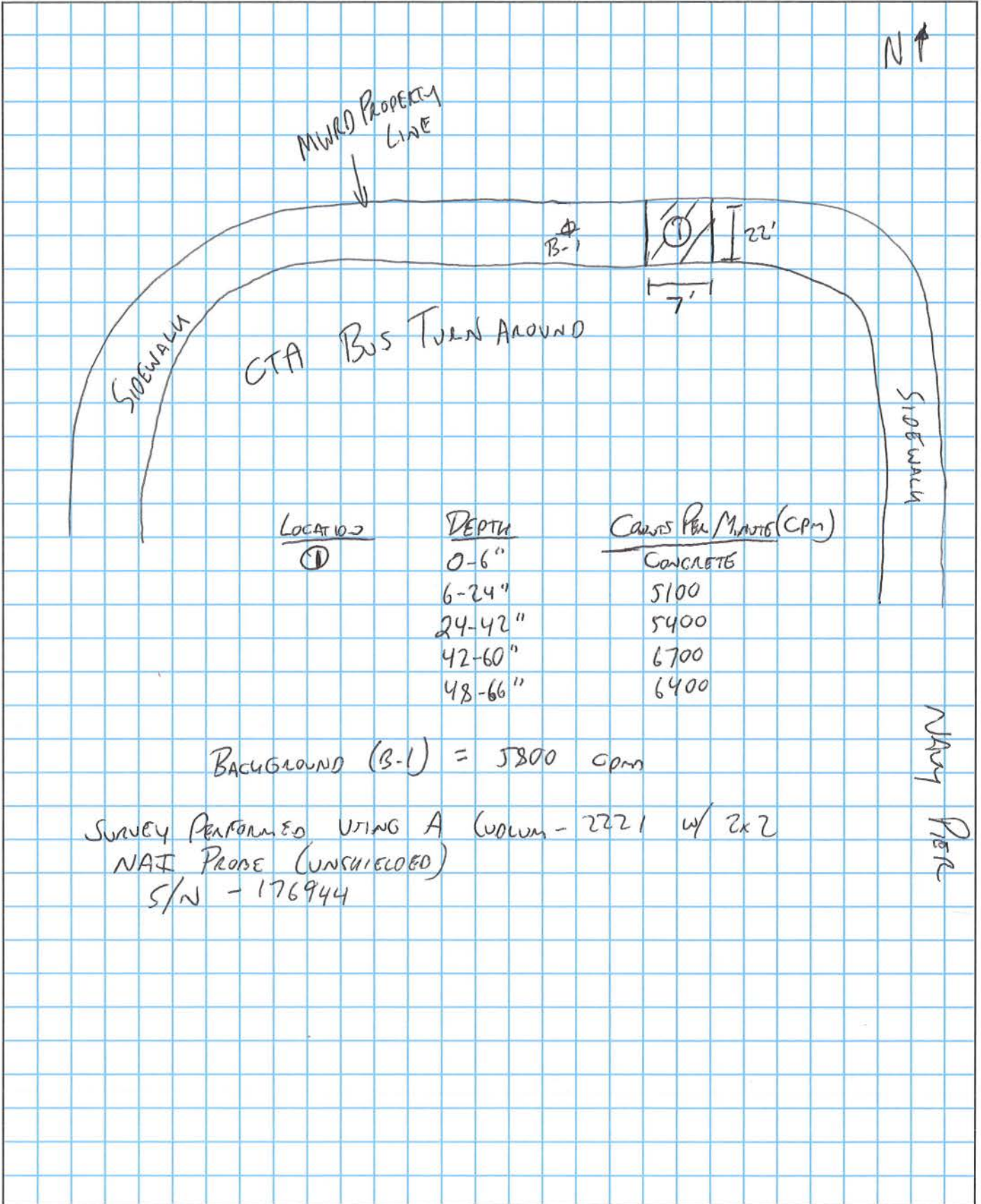

LOCATION	DEPTH	COUNTS PER MINUTE (CPM)
①	0-6"	CONCRETE
	6-24"	5100
	24-42"	5400
	42-60"	6700
	48-66"	6400

BACKGROUND (B-1) = 5800 cpm

SURVEY PERFORMED USING A (VOLUM - 2221 w/ 2x2 NAI PROBE (UNSHIELDED) S/N - 176944