



AECOM  
303 E. Wacker Drive, Suite 900  
Chicago, Illinois 60601

312-938-0300 tel  
312-938-1109 fax

October 9, 2012

Mr. Narendra Prasad  
People's Gas Light & Coke Co.  
Environmental Services Department  
130 East Randolph, 22nd Floor  
Chicago, IL 60601

RE: Radiological Survey of Right-of-Way Utility Excavation  
Permit No.: 277659200  
Permit Address: 432-440 East Grand Avenue  
AECOM Project No. 60157647

Dear Mr. Prasad:

Pursuant to conditions specified in a permit (see attached) issued by the City of Chicago, radiation monitoring was required to be performed at the above referenced site. AECOM Technical Services, Inc. (AECOM) provided the required radiation surveillance completed on the day of October 5, 2012 for an excavation to install an anode on existing gas service piping.

Surveying was performed for the soil removed from a 3-foot by 3-foot excavation along the sidewalk of East Grand Avenue (see sketch) to a depth of 4-feet below ground surface required for installation of an anode on existing gas service piping. The monitoring revealed no indication of soils above the specified clean-up value established by the U. S. Environmental Protection Agency (USEPA) for the Streeterville area of Chicago. The USEPA clean-up value for Chicago's Streeterville area is 7.1 picocuries per gram (pCi/g total radium (Ra-226 + Ra-228)).

Gamma radiation count measurements for the project were made using Ludlum Model 2221 survey meter and an unshielded 2 x 2 inch NaI probe (Model 44-10). For the instrument used, the gamma count threshold equivalent to the 7.1 pCi/g clean-up value was 20,356 counts per minute (cpm) unshielded (7,567 cpm shielded). The field gamma background for the area was measured at approximately 5,980 cpm unshielded. The field gamma measurements within the excavation and of the spoil materials generated during the excavation process did not exceed the respective field instrument threshold value previously stated and ranged from a minimum of 5,700 cpm to a maximum of 9,400 cpm unshielded. Thus, there was no indication of the presence of radiologically-contaminated material and/or an exceedance of the USEPA cleanup value of 7.1 pCi/g total radium.

As part of the permit conditions this letter has been forwarded to:

Chicago Department of Public Health  
Attention: Ms. Rahmat Begum  
333 South State Street, Rm. 200  
Chicago, Illinois 60604

Radiological Survey of Right-of-Way Utility Excavation  
Permit No.: 277659200  
Page 2

Please contact us with any questions you have regarding this letter or the reported results.

Regards,

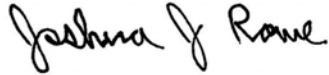

Joshua J. Rowe  
Project Scientist II



Steven C. Kornder, Ph.D.  
Senior Project Geoscientist

cc: Rahmat Begum, Chicago Department of Public Health  
Verneta Simon, USEPA

Attachments: Permit  
Sketch



DEPARTMENT OF PUBLIC HEALTH  
CITY OF CHICAGO

FORM NO. CDPH.ROW.03

Notice is hereby given that the site you have requested a permit for is recorded with the City of Chicago Department of Public Health (CDPH) as potentially having environmental contamination on the site and adjacent right-of-way. This environmental contamination could present a threat to human health and safety in connection with work performed at the site, or in the adjacent right-of-way, if proper safeguards are not employed.

A file containing detailed information regarding the aforementioned environmental contamination is available for review at CDPH at 33 N. LaSalle St., Suite LL-120, Chicago, Illinois 60602 during normal business hours (8:30AM-4:30PM, Monday through Friday). Contact (312) 744-3152 for an appointment. This file must be reviewed and the remainder of this form completed before the permit can be issued if the ground is exposed or excavated. Please note that for some locations, additional health and safety procedures may be required by law.

Please complete the following:

I have reviewed and understand the documents, maintained by CDPH, regarding environmental contamination of the site and adjacent right-of-way. Further, I will ensure that all work at the subject site and adjacent right-of-way, and any monitoring required including but not limited to radiation monitoring, will be performed in a manner that is protective of human health and the environment and in compliance with all applicable local, state, and federal laws, rules, and regulations, especially those pertaining to worker safety and waste management. I will ensure that the results of any radiation monitoring and/or surveying conducted shall be provided to the CDPH and the United States Environmental Protection Agency within two (2) weeks of their completion. If any elevated levels of radioactive material are detected, I will immediately contact the United States Environmental Protection Agency at (800) 424-8802.

Applicant Name (print): David O. Oliver

Signature: David O. Oliver

Site Address and Work Location (Describe exact site location and attach map): 432-440 E. Grand St.

Nature of Work: Excavation

Company Name, Address, Phone No.: Peoples Gas, 130 E. Randolph, (773) 240-4612

General / Prime Contractor Name, Address, Phone No.: Nate Cichon, 130 E. Randolph, (773) 542-7761

Safety Officer / Phone No. (include subcontractor information if applicable): Jake Wilbur, (773) 542-7538

Radiation Contractor / Phone No (if applicable): AECOM, Inc. Steve Kornder (847) 279-2511

Check if City Department Work  Department Name: \_\_\_\_\_

CDOT Permit No.: \_\_\_\_\_

Today's Date: 9/27/12 Expected Start Date: ASAP

CDPH Approval / Date: Rahmetunsa Begum

Please return this completed form to the Chicago Department of Transportation, Division of Infrastructure Management, Public Way Permit Office, City Hall - Room 905, 121 N. LaSalle St., Chicago, Illinois 60602 during normal business hours (8:30 AM - 4:30 PM, Monday through Friday)

For CDPH Use Only

JOB TITLE Integrys - 432-440 E Grand  
 JOB NO. 60157647 CALCULATION NO. \_\_\_\_\_  
 ORIGINATOR Joshua Rowe DATE 10/5/12  
 REVIEWER Steve Kornder DATE 10/5/12  
 SCALE not to scale SHEET NO. 1 OF 1

Meter S/N 172039  
 cut off 20,356 cpm unshielded

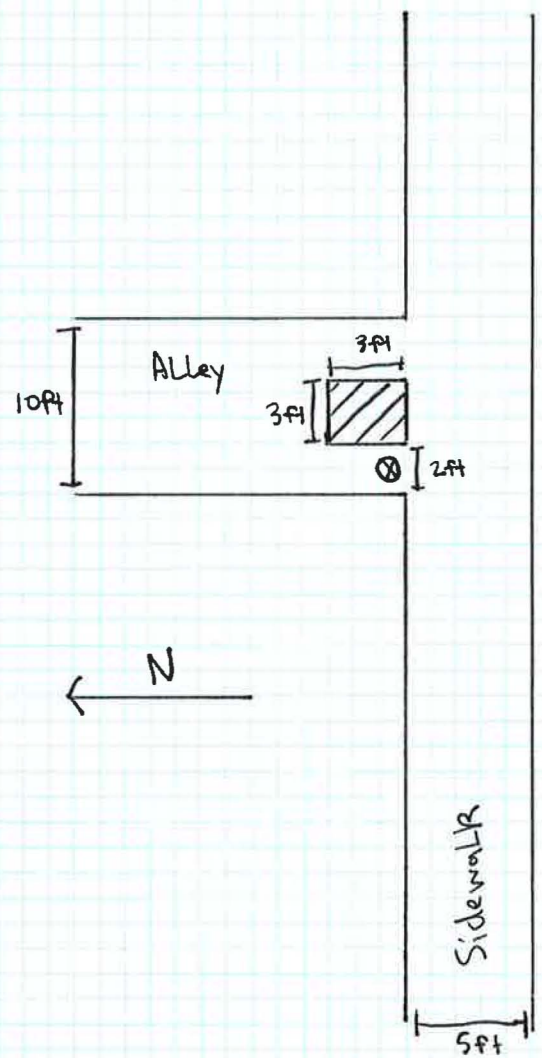

⊗ background 5980 cpm

Grand

Depth	Counts per Minute
0-6"	asphalt
6-24"	5700
24-42"	8600
42-60"	9400