



AECOM  
303 E. Wacker Drive, Suite 900  
Chicago, Illinois 60601

312-938-0300 tel  
312-938-1109 fax

June 25, 2012

Mr. Narendra Prasad  
People's Gas Light & Coke Co.  
Environmental Services Department  
130 East Randolph, 22nd Floor  
Chicago, IL 60601

RE: Radiological Survey of Right-of-Way Utility Excavation  
Permit No.: 266482668  
Permit Address: 400-434 East Randolph Street  
AECOM Project No. 60157647

Dear Mr. Prasad:

Pursuant to conditions specified in a permit (see attached) issued by the City of Chicago, radiation monitoring was required to be performed at the above referenced site. AECOM Technical Services, Inc. (AECOM) provided the required radiation surveillance completed on the day of June 25, 2012 for an excavation to install an anode on existing gas service piping.

Surveying was performed for the soil removed from a 2-foot by 3-foot excavation along the sidewalk of East Randolph Street (see sketch) to a depth of 4-feet below ground surface required for installation of an anode on existing gas service piping. The monitoring revealed no indication of soils above the specified clean-up value established by the U. S. Environmental Protection Agency (USEPA) for the Streeterville area of Chicago. The USEPA clean-up value for Chicago's Streeterville area is 7.1 picocuries per gram (pCi/g total radium (Ra-226 + Ra-228)).

Gamma radiation count measurements for the project were made using Ludlum Model 2221 survey meter and an unshielded 2 x 2 inch NaI probe (Model 44-10). For the instrument used, the gamma count threshold equivalent to the 7.1 pCi/g clean-up value was 20,356 counts per minute (cpm) unshielded (7,567 cpm shielded). The field gamma background for the area was measured at approximately 5,800 cpm unshielded. The field gamma measurements within the excavation and of the spoil materials generated during the excavation process did not exceed the respective field instrument threshold values previously stated and ranged from a minimum of 6,500 cpm to a maximum of 7,300 cpm unshielded. Thus, there was no indication of the presence of radiologically-contaminated material and/or an exceedance of the USEPA cleanup value of 7.1 pCi/g total radium.

As part of the permit conditions this letter has been forwarded to:

Chicago Department of Public Health  
Attention: Ms. Rahmat Begum  
333 South State Street, Rm. 200  
Chicago, Illinois 60604

Radiological Survey of Right-of-Way Utility Excavation  
Permit No.: 266482668  
Page 2

Please contact us with any questions you have regarding this letter or the reported results.

Regards,

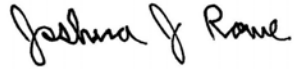

Joshua J. Rowe  
Project Scientist II



Steven C. Kornder, Ph.D.  
Senior Project Geoscientist

cc: Rahmat Begum, Chicago Department of Public Health  
Verneta Simon, USEPA

Attachments: Permit  
Sketch

**Permit # 266482668**

Received Date: Jun 12, 2012 3:11:15

**PEOPLES GAS LIGHT & COKE CO  
130 EAST RANDOLPH  
DRIVE  
CHICAGO, IL 60601**



**City of Chicago  
Department of Transportation  
(312) 744-4652**

**NIELSEN, RACHEL E 773-542-7830**

### **ACTIVITY HOURS**

**Start no earlier than 9 AM. Stop no later than 4 PM. - Sidewalk & Parkway  
Opening(s)**

### **DATES**

**Jun 12, 2012 through Jun 30, 2012**

### **ACTIVITIES**

**Sidewalk & Parkway Opening(s):**

**Dig #: TBD**

There will be 1 for the purpose of CORROSION WORK.

3 Feet x 5 Feet x 5 Feet.

Excavation may commence on - NO SOONER.

400 - 434 E RANDOLPH ST

LOWER RANDOLPH  
WORK TO BE PERFORM BY MEADE ELECTRIC  
OK MIKE SIMON.

OK TO RELEASE PER RAHMAT BEGUM ON 6/15/12

### **Restrictions:**

1. A copy of the permit must remain on-site for inspector's review.
2. Permit fees must be paid within 24 hours of the date of issuance. Failure to pay will result in you being considered in violation of the terms and agreement of the permit and subject to any

**Restrictions:**

applicable fine and fees as if you never attained a permit. Additionally, you will still be responsible for the cost of the original permit. Monthly billing accounts are not applicable to the 24 hour payment criteria but failure to pay the monthly bill by the due date will result in the same penalties applying.

3. All directional boring must be pre-approved by the Office of Underground Coordination.
4. Contractor must secure plating over all openings in the roadway and secure all sidewalk/parkway openings during non-working hours until such time when the road surface is restored.
5. Contractor must notify DIGGER at 312-744-7000 no less than 48 hours (exclusive of Saturdays, Sundays and Holidays) but no more than 14 calendar days in advance of the start of the excavation or demolition, unless the excavation date was provided with the application and remains unchanged. Prior to 26 calendar days the Contractor must notify DIGGER to renew the dig date!
6. It is the Excavator's responsibility to request refreshing of marks when needed, but no longer than 28 calendar days after the last requested date.
7. When applicable, all excavation areas are to be clearly marked in safety white paint prior to calling DIGGER. White paint is not required for joint meets or emergency work.
8. Excavators requesting dig tickets are responsible for the protection of utility markings at the job site. Any markings of underground utilities utilizing utility colors, must be done by facility owners or authorized agents only.
9. Permittee must provide a sign which identifies the telephone number and company or person performing the work. Signage may be affixed to barricades.
10. Permanent base pavement restoration to follow within 5 days after the completion of underground work.
11. All pavements and pavement markings are to be restored in accordance with CDOT Construction Standards.
12. Work to be performed as per plans and specifications.
13. Use of pneumatic equipment must not begin before 8:00 A.M. or continue after 8:00 P.M.
14. Maintain pedestrian traffic at all times.
15. Pavement opening to be backfilled to grade/or plated during off work hours.
16. Parkway excavation by hand, cut and replace sod wherever possible.
17. Permittee to provide all barricades, signs and/or flagmen as necessary.
18. Sidewalk pavement broken by hand or with pneumatic hammer only.
19. No work in or use of the public right of way is to be done when a special event is taking place. It is up to the applicant to determine if an event is scheduled. To obtain a listing of programs or events within the City of Chicago please dial 311 when you are within the City boundaries.
20. It is the responsibility of the applicant to fund Traffic Control Aides if the City deems it necessary due to heavy congestion situations.
21. Pursuit to City Ordinances 10-20-150 and 10-28-281.3 a re-inspection fee of \$100 may be assessed for each inspection conducted after the initial inspection.

**Sidewalk & Parkway Opening(s)**

06-18-2012 - Fee Pavement Opening

CBD:	Y	Cost Per EA: \$	391.00	CAPS:	300-84-2135-256
Tiered:	N	# Of EA:	1.00	Late charge: \$	.00
Mora:	N			Amount: \$	391.00

**Total Fees: \$ 391.00**

**Grand Total Fees: \$ 391.00**

Affected CUAN Sites: 7, 15, 20, 21, 22, 24, 28, 29, 31, 34, 38, 53, 61, 68, 70, 86, 141, 147

**EFFECTIVE DATES OF PERMIT**

Current: Jun 12, 2012 through Jun 30, 2012 ( Input date: Jun 12, 2012 3:11:15 p.m. )

**END OF PERMIT**

Meter SIN 172039  
 cut off 20,356 cpm unshielded

Randolph

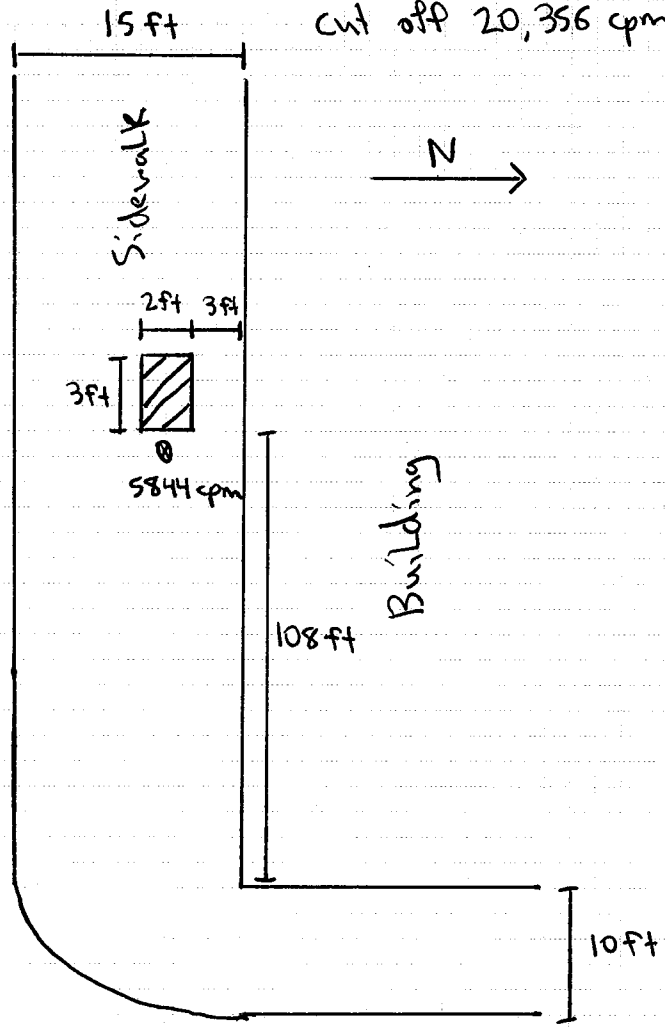

<u>Depth</u>	<u>Counts per Minute</u>
0-6"	concrete
6-12"	7000
12-24"	7300
24-36"	7100
36-48"	6500