



AECOM
303 E. Wacker Drive, Suite 1400
Chicago, Illinois 60601

312-373-7500 tel
312-373-7510 fax

February 16, 2015

Mr. Mike Jouras
People's Gas Light & Coke Co.
Environmental Services Department
130 East Randolph, 22nd Floor
Chicago, IL 60601

RE: Radiological Survey of Right-of-Way Utility Excavation
Permit No.: 475881807
Permit Address: 224 East Ontario Street
AECOM Project No. 60157647

Dear Mr. Jouras:

Pursuant to conditions specified in a permit (see attached) issued by the City of Chicago, radiation monitoring was required to be performed at the above referenced site. AECOM Technical Services, Inc. (AECOM) provided the required radiation surveillance on February 16, 2015 for an excavation to decommission an existing gas service line located at 224 East Ontario Street.

Surveying was performed on both the soil removed from a 3-foot by 5-foot trench and within the roadway of East Ontario Street, south of the permitted address (see sketch). The maximum depth of the excavation was approximately 4-feet below ground surface. Backfill in the vicinity of the gas main was primarily clean tan sand above areas of the existing gas service utility encountered within the excavation. The monitoring revealed no indication of fill soil above the clean-up value established by the U. S. Environmental Protection Agency (USEPA) for the Streeterville area of Chicago. The USEPA cleanup value for Chicago's Streeterville area is 7.1 picocuries per gram (pCi/g) total radium (Ra-226 + Ra-228).

Gamma radiation count measurements for the project were made using Ludlum Model 2221 survey meter and an unshielded 2 x 2 inch NaI probe (Model 44-10). For the instrument used, the gamma count threshold equivalent to the 7.1 pCi/g cleanup value is 18,279 counts per minute (cpm) unshielded (6,282 cpm shielded). The field gamma background for the area was measured at approximately 6,498 cpm unshielded as measured at the exposed soil within a tree planter near the vicinity of the excavation at the permitted address.

The field gamma measurements within the excavation during the excavation process did not exceed the instrument threshold previously stated and ranged from a minimum of 6,200 cpm to a maximum of 7,500 cpm unshielded. Thus, there was no indication of the presence of radiologically-contaminated material and/or an exceedance of the USEPA cleanup value of 7.1 pCi/g total radium. A copy of the permit and a field sketch documenting the area where work was performed have been included as attachments.

As part of the permit conditions this letter has been forwarded to:

Chicago Department of Public Health
Attention: Ms. Rahmat Begum
333 South State Street, Room 200
Chicago, Illinois 60604

Please contact us with any questions you have regarding this letter or the reported results.

Regards,



Brian R. Schmidt
Project Scientist II



Steven C. Kornder, Ph.D.
Senior Project Geoscientist

cc: Rahmat Begum, Chicago Department of Public Health
Verneta Simon, USEPA

Attachments: Permit
Sketch

PERMIT

Permit # 475881807

AMENDED



Received Date: Sep 15, 2014 12:46:34

**PEOPLES GAS LIGHT & COKE CO
130 EAST RANDOLPH
DRIVE
CHICAGO, IL 60601**

**City of Chicago
Department of Transportation
(312) 744-4652**

HERMAN 773-542-7830

ACTIVITY HOURS

**Start no earlier than 9 AM. Stop no later than 4 PM. - Street Opening
(Curb Lane & Traffic Lane)**

DATES

Feb 9, 2015 through Feb 23, 2015

ACTIVITIES

Street Opening (Curb Lane & Traffic Lane):

Dig #: TBD

There will be 1 opening(s) in the public way for the purpose: SERVICE CUT
OFF WRECKING.

3 Feet x 5 Feet x 5 Feet

Excavation may commence on - NO SOONER.

224 E ONTARIO ST

RESTORATION REQUIREMENTS - 13X15
OK INSPECTOR G.K 11/10/14

RESTORATION IS THE RESPONSIBILITY OF THE GENERAL
CONTRACTOR
MUST MAINTAIN 2 WB LANES AT ALL TIMES

PERIMETER PAVING

ENVIRONMENT SIGN OFF BY RAHMAT BEGUM ON 9/30/14

Street Opening (Curb Lane & Traffic Lane):

Dig #: TBD

OK M SIMON

Restrictions:

1. A copy of the permit must remain on-site for inspector's review.
2. Permit fees must be paid within 24 hours of the date of issuance. Failure to pay will result in you being considered in violation of the terms and agreement of the permit and subject to any applicable fine and fees as if you never attained a permit. Additionally, you will still be responsible for the cost of the original permit. Monthly billing accounts are not applicable to the 24 hour payment criteria but failure to pay the monthly bill by the due date will result in the same penalties applying.
3. All directional boring must be pre-approved by the Office of Underground Coordination.
4. Contractor must secure plating over all openings in the roadway and secure all sidewalk/parkway openings during non-working hours until such time when the road surface is restored.
5. All traffic control will be the responsibility of the contractor and must comply with all MUTCD standards.
6. Work permitted only between
7. Restore all lanes to normal operation during non-working hours.
8. Must use flagmen and/or arrow boards to maintain traffic operations through the work zone.
9. Contractor must notify DIGGER at 312-744-7000 no less than 48 hours (exclusive of Saturdays, Sundays and Holidays) but no more than 14 calendar days in advance of the start of the excavation or demolition, unless the excavation date was provided with the application and remains unchanged. Prior to 26 calendar days the Contractor must notify DIGGER to renewal the dig date!
10. It is the Excavator's responsibility to request refreshing of marks when needed, but no longer than 28 calendar days after the last requested date.
11. When applicable, all excavation areas are to be clearly marked in safety white paint prior to calling DIGGER. White paint is not required for joint meets or emergency work.
12. Excavators requesting dig tickets are responsible for the protection of utility markings at the job site. Any markings of underground utilities utilizing utility colors, must be done by facility owners or authorized agents only.
13. Pursuit to City Ordinances 8-32-140 through 170 use of pneumatic equipment must not begin before 8:00 A.M. or continue after 8:00 P.M.
14. Permittee must provide a sign which identifies the telephone number and company or person performing the work. Signage may be affixed to barricades.
15. Permanent base pavement restoration to follow within 5 days after the completion of underground work.

Restrictions:

- 16. All pavements and pavement markings are to be restored in accordance with CDOT Construction Standards.
- 17. All street openings must be restored with concrete base to grade.
- 18. Work to be performed as per plans and specifications.
- 19. Streets recently resurfaced must be restored to proper standards (resurface to nearest 1/4 pt, see CDOT Construction Standards for further details).
- 20. **WARNING: THIS WORKSITE(S) CONTAINS RADIOACTIVE MATERIAL. ANY QUESTIONS PERTAINING TO HANDLING OF MATERIALS, CONTACT THE DEPT. OF ENVIRONMENT AT 312-744-3152.**
- 21. This worksite is a MORATORIUM STREET and must be restored to CDOT standards.
- 22. **BIKE FACILITY:** On streets with bike markings and/or bike signage the CDOT Bike Program can provide existing pavement marking plans and details. Please contact CDOT Bike Program representative Bradley Topol in advance of activity to ensure restoration of pavement markings. Contact at (312) 744-0513 or at CDOTBikes@cityofchicago.org

SHARED LANE YIELD TO BIKES signs must be posted if bike traffic is shared with vehicular traffic. Please see the CDOT Rules and Regulations For Construction in the Public Way for more guidance on bike temporary traffic control.

- 23. No work in or use of the public right of way is to be done when a special event is taking place. It is up to the applicant to determine if an event is scheduled. To obtain a listing of programs or events within the City of Chicago please dial 311 when you are within the City boundaries.
- 24. It is the responsibility of the applicant to fund Traffic Control Aides if the City deems it necessary due to heavy congestion situations.
- 25. Pursuit to City Ordinances 10-20-150 and 10-28-281.3 a re-inspection fee of \$100 may be assessed for each inspection conducted after the initial inspection.
- 26. All metal plates used for public way construction or placed within the right-of-way must indicate Ownership!

Street Opening (Curb Lane & Traffic Lane)

02-09-2015 - Fee Pavement Opening					
CBD:	Y	Cost Per EA: \$	454.00	CAPS:	300-84-2135-256
Tiered:	N	# Of EA:	1.00	Late charge: \$.00
Mora:	Y			Amount: \$	864.00

Total Fees: \$ 864.00

Grand Total Fees: \$ 864.00

Affected CUAN Sites: 7, 15, 18, 21, 22, 24, 28, 29, 31, 34, 36, 38, 53, 61, 68, 70, 73, 79, 141, 147

EFFECTIVE DATES OF PERMIT

Current: Feb 09, 2015 through Feb 23, 2015 (Input date: Nov 12, 2014 4:18:45 p.m.)
Previous: Sep 15, 2014 through Feb 23, 2015 (Input date: Feb 09, 2015 4:18:38 p.m.)
Previous: Sep 15, 2014 through Sep 30, 2014 (Input date: Sep 15, 2014 12:46:34 p.m.)

END OF PERMIT

SKETCH

JOB TITLE 224 E. ONTARIO ST. ROW - RADIOLOGICAL SURVEY
 JOB NO. 6015-~~1047~~ T.57 CALCULATION NO. _____
 ORIGINATOR BRIAN SCHMIOT DATE 2/16/15
 REVIEWER STEVE KANDLER DATE 2/16/15
 SCALE N/A SHEET NO. 1 OF 1

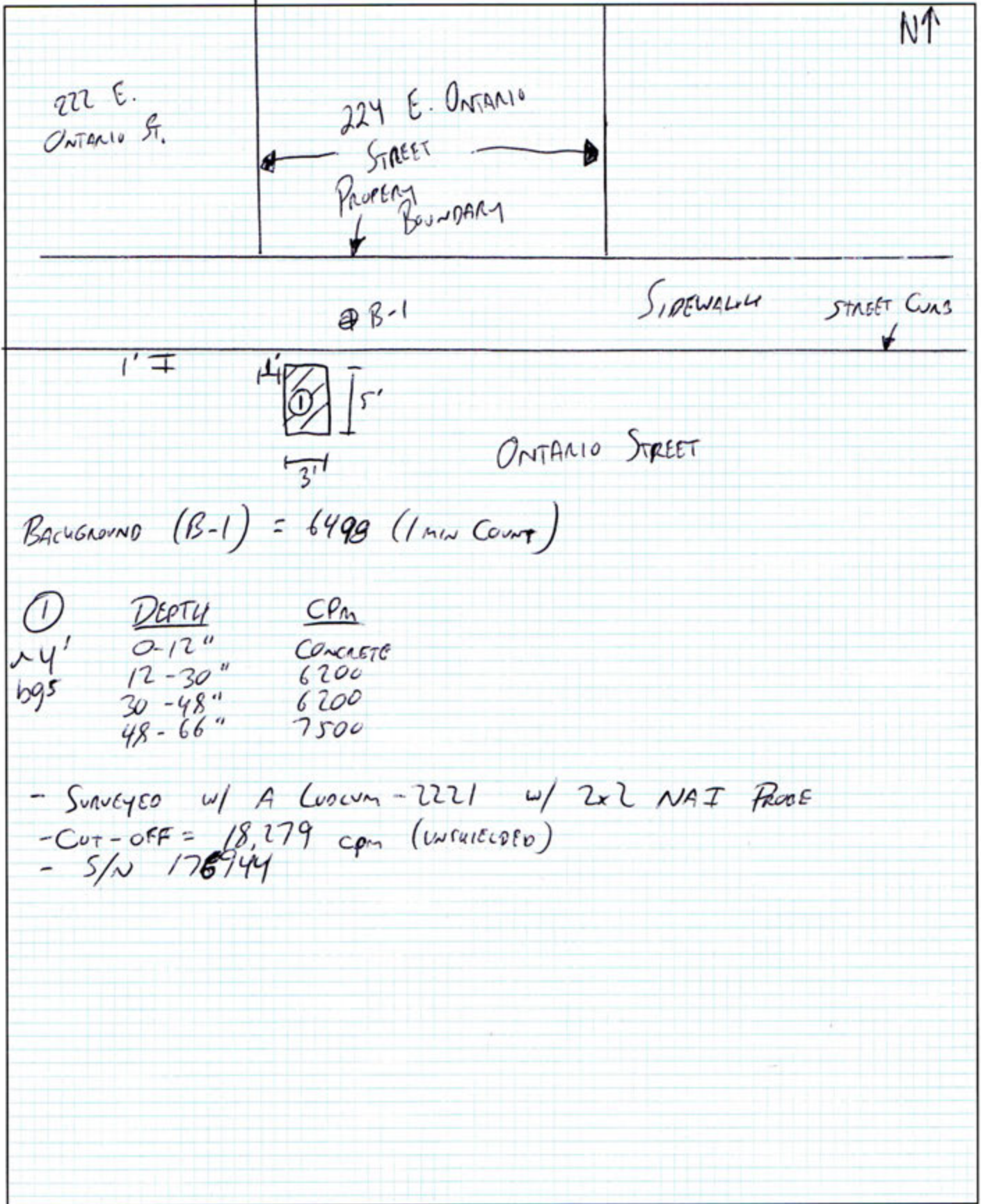

BACKGROUND (B-1) = 6499 (1 min count)

①	DEPTH	CPM
~4' bgs	0-12"	CONCRETE
	12-30"	6200
	30-48"	6200
	48-66"	7500

- SURVEYED w/ A LUCCUM-2221 w/ 2x2 NAI PROBE
- CUT-OFF = 18,279 cpm (UNRECORDED)
- S/N 176744