

Weekly Field Report
Week: 01-19-14 through 01-25-14
New Bedford Harbor Lower Harbor CAD Cell (LHCC)

This Weekly Field Report was prepared to serve as a summary of field activities conducted throughout the week for Phase I dredging of the New Bedford Harbor Lower Harbor CAD Cell (LHCC) in New Bedford, Massachusetts.

1. Introduction:

The weekly field report describes the activities carried out by the Contractor (Cashman/Tripp Marine), the Owner's Representative (Apex Companies, LLC), and any subcontractors completing work within the scope of the project requirements.

This Weekly Field Report represents the twelfth Report associated with Phase I dredging of the LHCC in New Bedford Harbor, and the associated handling and disposal of dredged materials at CAD cells within the Harbor, and at designated open-water disposal sites approved for this Project.

This 12th Report for the LHCC dredging activities includes:

- Daily Inspection Reports from the dredging oversight performed during the week of January 19th through January 25th, 2014. Daily contractor activities are included in the form of Daily Inspection Reports noting equipment observed on site and a summary of contractor activities. (See Attachment 1);
- Water Quality Monitoring Forms completed for the week of January 19th through January 25th, 2014 are attached (See Attachment 2). Included with the attached forms is Figure 1 Lower Harbor CAD Cell Phase I Water Quality Monitoring Plan, which shows the locations of the water quality monitoring events conducted during this reporting period. Per the approved Water Quality Monitoring Plan and associated performance standards for the dredging efforts being conducted during this reporting period, Apex has:
 - Conducted water quality monitoring a minimum of one day per week, with the intent of monitoring the first three days of construction activities.
 - Performed visual inspections of dredged materials in the disposal scow for any visible debris or other items that could potential become a hazard to navigation prior to scow's departure for the offshore disposal site.

Summary:

The Contractor through its subcontractor, Tripp Marine conducted dredging at the LHCC January 24th and 25th. Dredging operations focused on the strategic removal of Phase I Bottom of CAD Cell sediments to open up a 125-foot wide deepwater access channel for larger barge mounted dredge equipment expected on site. During this reporting period dredging operations were conducted using a conventional digging bucket, with dredged materials being disposed offshore at the Rhode Island Sound Disposal Site (RISDS). Tripp Marine was observed conducting these activities during the authorized operational window of 7AM until sunset, utilizing a single dredge plant; the tug *Sand Pebble*; a 900 cubic yard dump scow – *TMC 140*; and two small utility boats. With time of year restrictions now in place (January 15th through June 15th) all dredging activities were conducted within a silt curtained perimeter surrounding the LHCC.

2. Operational Notes:

Dredging:

Dredging of the Bottom of CAD materials at LHCC started this week on January 24th. Dredging operations focused on the strategic removal of Phase I Bottom of CAD Cell sediments to open up a 125-foot wide deep water access channel. Apex conducted two days of water quality monitoring while the bottom of CAD activities were being started to ensure that the activities did not result in an exceedance of any project-specific water quality standards. Water quality monitoring was completed January 24th and 25th, while dredging operations were occurring. Dredging operations were limited on the 25th due to high wind conditions.

Offshore Disposal:

Offshore disposal for Bottom of CAD sediments is scheduled and permitted for the Rhode Island Sound Disposal Site. No offshore disposal events occurred during the week of January 19th through January 25th due to limited dredging activities and weather conditions.

Table 1 – Cumulative Dredging Progress

Period of Activity	Volume (cy)
Approximate Top of CAD Volume Dredged to Date*	24,890
Approximate Bottom of CAD Volume Dredged this Reporting Period	600
Approximate Bottom of CAD Volume Dredged to Date*	600

*Dredged volume quantities are estimated based on observed scow draft marks and an assumed density of the materials dredged. Given the uncertainty in the density of a composite mix of sediments being dredged, all volumes are confirmed and adjusted as necessary using bathymetric survey data

3. Monitoring Summary

There were no water quality exceedances observed during this reporting period related to dredging operations. No water quality samples were collected.

Prepared by:
Apex Companies, LLC



John B. McAllister, P.E.
Senior Project Engineer



Don Boyé
Senior Project Manager

Attachment 1
Daily Inspection Reports



City of New Bedford Harbor Development Commission
New Bedford Harbor USEPA Lower Harbor CAD Cell
CFDA No.: 66.802
Inspection Report

Inspector: Chris Stillman

Date: 20 January 2014

Contractor: Tripp Marine

Foreman/Supt: Tripp Pyne

Weather	AM:	<u>Clear</u>	Temperature	AM:	<u>30</u>
	PM:	<u>Cloudy</u>		PM:	<u>45</u>

Tides	High	<u>1012</u>	AM	<u>2245</u>	PM
	Low	<u>321</u>	AM	<u>1542</u>	PM

Manpower Onsite

Foreman 0 @ 0 Hrs
Operators 0 @ 0 Hrs
Laborers 0 @ 0 Hrs
Drivers _____ @ _____ Hrs

Other: _____ @ _____ Hrs

Equipment Onsite

Description: Dredge Tripp 47 Hrs. 0
Scow TMC 140 Hrs. 0
Push boat Sand Pebble Hrs. 0
Support boat Hrs. 0
Scow SEI 2000 Hrs. _____

Contractor Activities: (Attach Additional Sheets as Necessary)

0530 Apex on site - no activity at this time. 1317 Apex on site, still no activity at this time.

Problems/Issues or Action Items:

Visitors: _____

Signature: K Ryan

Date: 20 January 2014

Title: _____

Page: 1 of 1

Copy to: file

File: DIR_LHCC_011814



City of New Bedford Harbor Development Commission
New Bedford Harbor USEPA Lower Harbor CAD Cell
CFDA No.: 66.802
Inspection Report

Inspector: C Stillman **Date:** 21 January 2014

Contractor: Tripp Marine **Foreman/Supt:** Pyne Tripp

Weather AM: Clear **Temperature** AM: 14
PM: Cloudy PM: 29

Tides High 1054 AM 2329 PM
Low 0400 AM 1616 PM

Manpower Onsite

Foreman 0 @ 0 Hrs
Operators 0 @ 0 Hrs
Laborers 0 @ 0 Hrs
Drivers _____ @ _____ Hrs

Other: _____ @ _____ Hrs

Equipment Onsite

Description: Dredge Tripp 47 Hrs. 0
Scow TMC 140 Hrs. 0
Push boat Sand Pebble Hrs. 0
Support boat Hrs. 0
Scow SEI 2000 Hrs. 0

Contractor Activities: (Attach Additional Sheets as Necessary)

0624 Apex on site, no activity at this time. 1421 Still no activity on site, after periodic checks throughout the day and confirmation from the Dredge Captain.

Problems/Issues or Action Items:

Visitors:

Signature: K Ryan

Title: _____

Copy to: file

Date: 21 January 2014

Page: 1 of 1

File: DIR_LHCC_012114



City of New Bedford Harbor Development Commission
New Bedford Harbor USEPA Lower Harbor CAD Cell
CFDA No.: 66.802
Inspection Report

Inspector: K Ryan

Date: 22 January 2014

Contractor: Tripp Marine **Foreman/Supt:** Pyne Tripp

Weather	AM:	<u>Overcast</u>	Temperature	AM:	<u>7</u>
	PM:	<u>Clear</u>		PM:	<u>17</u>

Tides	High	<u>1143</u>	AM	<u> </u>	PM
	Low	<u>0442</u>	AM	<u>1656</u>	PM

Manpower Onsite

Foreman 0 @ 0 Hrs
Operators 0 @ 0 Hrs
Laborers 0 @ 0 Hrs
Drivers 0 @ 0 Hrs

Other: _____ @ _____ Hrs

Equipment Onsite

Description: Dredge Tripp 47 Hrs. 0
 Scow TMC 140 Hrs. 0
 Push boat Sand Pebble Hrs. 0
 Support boat Hrs. 0
 Scow SEI 2000 Hrs. 0

Contractor Activities: (Attach Additional Sheets as Necessary)

0548 Apex on site not activity at this time. 0847 No activity at this time. 1526 Still no activity at this time, including periodic checks throughout the day. No activity for the day confirmed by the Dredge Captain.

Problems/Issues or Action Items:

Visitors:

Signature: K Ryan

Title: _____

Copy to: file

Date: 22 January 2014

Page: 1 of 1

File: DIR_LHCC_012214



City of New Bedford Harbor Development Commission
New Bedford Harbor USEPA Lower Harbor CAD Cell
CFDA No.: 66.802
Inspection Report

Inspector: C Stillman

Date: 23 January 2014

Contractor: Tripp Marine

Foreman/Supt: Pyne Tripp

Weather	AM:	<u>Clear</u>	Temperature	AM:	<u>4</u>
	PM:	<u>Clear</u>		PM:	<u>20</u>

Tides	High	<u>1217</u>	AM	<u>0031</u>	PM
	Low	<u>0533</u>	AM	<u>1746</u>	PM

Manpower Onsite

Foreman 0 @ 0 Hrs
Operators 0 @ 0 Hrs
Laborers 0 @ 0 Hrs
Drivers 0 @ 0 Hrs

Other: _____ @ _____ Hrs

Equipment Onsite

Description: Dredge Tripp 47 Hrs. 0
Scow TMC 140 Hrs. 0
Push boat Sand Pebble Hrs. 0
Support boat Hrs. 0
Scow SEI 2000 Hrs. 0

Contractor Activities: (Attach Additional Sheets as Necessary)

0530 Apex on site not activity at this time. 1217 No activity at this time. 1530 Still no activity at this time, including periodic checks throughout the day. No activity for the day confirmed by the Dredge Captain.

Problems/Issues or Action Items:

Visitors: _____

Signature: K Ryan

Title: _____

Copy to: file

Date: 23 January 2014

Page: 1 of 1

File: DIR_LHCC_012314



City of New Bedford Harbor Development Commission
New Bedford Harbor USEPA Lower Harbor CAD Cell
CFDA No.: 66.802
Inspection Report

Inspector: C Stillman **Date:** 24 January 2014

Contractor: Tripp Marine **Foreman/Supt:** Pyne Tripp

Weather AM: Clear **Temperature** AM: 7
PM: Clear PM: 17

Tides High 0109 AM 1327 PM
Low 0637 AM 1848 PM

Manpower Onsite

Foreman 1 @ 8 Hrs
Operators 1 @ 8 Hrs
Laborers 1 @ 8 Hrs
Drivers _____ @ _____ Hrs

Other: _____ @ _____ Hrs

Equipment Onsite

Description: Dredge Tripp 47 Hrs. 8
Scow TMC 140 Hrs. 8
Push boat Sand Pebble Hrs. 8
Support boat Hrs. 8
Scow SEI 2000 Hrs. 0

Contractor Activities: (Attach Additional Sheets as Necessary)

0505 Apex on site, no activity at this time. 0951 Pyne on site with Dredge Tripp 47, Sand Pebble, and skiff, they are dropping curtain, no dredging at this time. 1202 Pyne begins dredging into the TMC-140 inside the silt curtain. 1230 dredging is occurring in the middle of silt curtained area. 1320 the TMC - 140 is drafting at: bow 3' and stern 3.5'. 1438 Tripp continues to dredge into the TMC - 140 drafting at: bow 3.5' and the stern 7'. 1550 Tripp Marine is finished for the day.

Problems/Issues or Action Items:

Visitors: _____

Signature: K Ryan

Title: _____

Copy to: file

Date: 24 January 2014

Page: 1 of 1

File: DIR_LHCC_2014



City of New Bedford Harbor Development Commission
New Bedford Harbor USEPA Lower Harbor CAD Cell
CFDA No.: 66.802
Inspection Report

Inspector: K Ryan, J Thomson **Date:** 25 January 2014

Contractor: Tripp Marine **Foreman/Supt:** Pyne Tripp

Weather AM: Cloudy **Temperature** AM: 13
PM: Showers PM: 40

Tides High 0206 AM 1428 PM
Low 0753 AM 1956 PM

Manpower Onsite

Foreman 1 @ 1 Hrs
Operators 1 @ 1 Hrs
Laborers 1 @ 1 Hrs
Drivers _____ @ _____ Hrs

Other: _____ @ _____ Hrs

Equipment Onsite

Description: Dredge Tripp 47 Hrs. 1
Scow TMC 140 Hrs. 1
Push boat Sand Pebble Hrs. 1
Support boat Hrs. 1
Scow SEI 2000 Hrs. 0

Contractor Activities: (Attach Additional Sheets as Necessary)

0755 Tripp Marine is not on site at the moment, they did notify Apex they would be on site at 1100. 1205 Tripp Marine is on site, no dredging at this time. 1215 Tripp begins dredging into the TMC - 140. 1252 Tripp stops dredging for the day; TMC - 140 drafting at: bow 5.5 and the stern 9'.

Problems/Issues or Action Items:

1328 talked with Pyne Tripp he said they decided to stop dredging activities due to heavy winds. He also added that they will not be able to perform their disposal until 01/28/2014 due to inclement weather. They are permitted to dispose of their material at the Rhode Island off shore disposal site.

Visitors:

Signature: K Ryan

Title: _____

Copy to: file

Date: 25 January 2014

Page: 1 of 1

File: DIR_LHCC_012514

Attachment 2
Water Quality Monitoring Forms

PROJECT:	New Bedford Harbor Lower Harbor CAD Cell		
JOB NUMBER:	6724		
SURVEY DATE:	24 January 2014		
MONITORS:	M. Martinho		
WEATHER CONDITIONS:	Sunny / Clear	Low: 11	High: 15
WIND CONDITIONS:	Speed: 5-10k	Direction: NW	
PRIOR STORM EVENTS:	N/A		
DREDGE / SCOW Position:	Northing/Easting:		
TYPE OF WATER QUALITY MONITORING EVENT:	TOP CAD Dredging / BTM CAD Dredging / Disposal		
TIDE INFORMATION:	High: 0104/1325	Low: 0639/1847	
WAS WATER QUALITY SAMPLING PERFORMED? (YES/NO):	N IF YES, ATTACH COC FORMS		
GENERAL NOTES:	Dredging begins at 1202 for Bottom of CAD dredging which continued until 1550		



UP-CURRENT

Monitoring ID #	NORTHING / EASTING	TIME	TOTAL WATER DEPTH (ft)	SAMPLE DEPTH (ft)	TURBIDITY (NTUs)	GPS FILE NAME	TIDAL STAGE	RELATIVE POSITION OF MEASUREMENT	NUMBER OF HOURS DREDGING
012414-00-1-1	2696535 / 815046	1200	8.6	1	2.6		Flooding tide	200' S of Dredge	0
012414-00-1-4		1202		4	4				
012414-00-1-8		1204		8	4.5				
					AVERAGE TURBIDITY:	3.70			
012414-02-1-1	2697050 / 815113	1400	6.3	1	3.3		Ebbing	200' N of Dredge	2
012414-02-1-3		1402		3	3.9				
012414-02-1-6		1404		6	3.8				
					AVERAGE TURBIDITY:	3.67			
012414-04-1-1	2697025 / 814980	1600	5.8	1	3.4		Ebbing	200' N of Dredge	4
012414-04-1-2.5		1602		2.5	3.3				
012414-04-1-5		1604		5	3.2				
					AVERAGE TURBIDITY:	3.30			
					AVERAGE TURBIDITY:				
					AVERAGE TURBIDITY:				

Down-Current

Monitoring ID #	NORTHING / EASTING	TIME	TOTAL WATER DEPTH (ft)	SAMPLE DEPTH (ft)	TURBIDITY (NTUs)	GPS FILE NAME	TIDAL STAGE	DISTANCE FROM LOCATION	NUMBER OF HOURS DREDGING
012414-00-9-1	2697051 / 815065	1210	6	1	3.5		Flooding tide	200' N of Dredge	0
012414-00-9-2.5		1212		2.5	4.2				
012414-00-9-5		1214		5	4.6				
					AVERAGE TURBIDITY:	4.10			
					TURBIDITY INCREASE:	0.40			
012414-02-9-1	2696487 / 815217	1410	6.1	1	4.2		Ebbing	200' S of Dredge	2
012414-02-9-3		1412		3	4.4				
012414-02-9-5.5		1414		5.5	4.4				
					AVERAGE TURBIDITY:	4.33			
					TURBIDITY INCREASE:	0.67			
012414-04-9-1	2696604 / 814807	1610	13.2	1	5.4		Ebbing	200' S of Dredge	4
012414-04-9-6		1612		6	5.5				
012414-04-9-12		1614		12	5.3				
					AVERAGE TURBIDITY:	5.40			
					TURBIDITY INCREASE:	2.10			
					AVERAGE TURBIDITY:				
					TURBIDITY INCREASE:				
					AVERAGE TURBIDITY:				
					TURBIDITY INCREASE:				

* Turbidity Increase = Down-Current Average Turbidity - Up-Current Average Turbidity

PROJECT: New Bedford Harbor Lower Harbor CAD Cell
 JOB NUMBER: 6724
 SURVEY DATE: 25 January 2014
 MONITORS: K. Ryan, J. Thompson
 WEATHER CONDITIONS: Rain/Snow Mix Low: 12 High: 39
 WIND CONDITIONS: Speed: 15-20k Direction: SSW
 PRIOR STORM EVENTS: N/A
 DREDGE / SCOW Position: Northing/Easting:
 TYPE OF WATER QUALITY MONITORING EVENT: TOP CAD Dredging / BTM CAD Dredging / Disposal
 TIDE INFORMATION: High: 0200/1425 Low: 0758/1956
 WAS WATER QUALITY SAMPLING PERFORMED? (YES/NO): N IF YES, ATTACH COC FORMS
 GENERAL NOTES: Dredging begins at 1215 for Bottom of CAD dredging, which continued until 1252, after which activities stopped due to high wind conditions.



UP-CURRENT

Monitoring ID #	NORTHING / EASTING	TIME	TOTAL WATER DEPTH (ft)	SAMPLE DEPTH (ft)	TURBIDITY (NTUs)	GPS FILE NAME	TIDAL STAGE	RELATIVE POSITION OF MEASUREMENT	NUMBER OF HOURS DREDGING
012514-00-1-1	2696511 / 815138	1235	8.4	1	4.5		Flooding tide	200' S of Dredge	0
012514-00-1-4		1237		4	4.2				
012514-00-1-8		1239		8	7				
					AVERAGE TURBIDITY:	5.23			
					AVERAGE TURBIDITY:				
					AVERAGE TURBIDITY:				
					AVERAGE TURBIDITY:				
					AVERAGE TURBIDITY:				

Down-Current

Monitoring ID #	NORTHING / EASTING	TIME	TOTAL WATER DEPTH (ft)	SAMPLE DEPTH (ft)	TURBIDITY (NTUs)	GPS FILE NAME	TIDAL STAGE	DISTANCE FROM LOCATION	NUMBER OF HOURS DREDGING
012514-00-9-1	2697133 / 815207	1245	6.4	1	4.9		Flooding tide	200' N of Dredge	0
012514-00-9-3		1247		3	7.8				
012514-00-9-6		1249		6	6.6				
					AVERAGE TURBIDITY:	6.43			
					TURBIDITY INCREASE:	1.20			
					AVERAGE TURBIDITY:				
					TURBIDITY INCREASE:				
					AVERAGE TURBIDITY:				
					TURBIDITY INCREASE:				
					AVERAGE TURBIDITY:				
					TURBIDITY INCREASE:				

* Turbidity Increase = Down-Current Average Turbidity - Up-Current Average Turbidity

Figure 1
Lower Harbor CAD Cell Phase I – Water Quality Monitoring

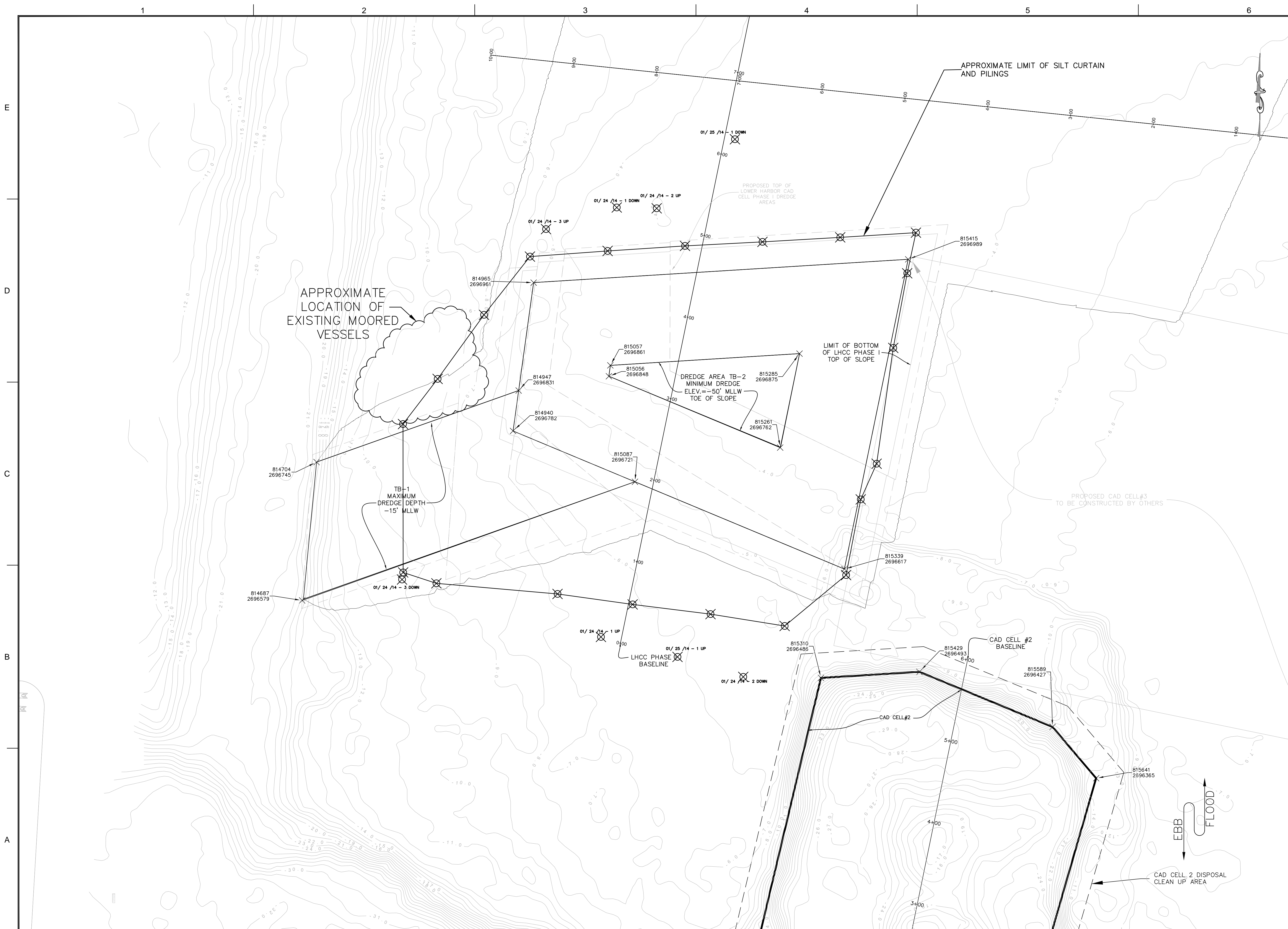

ROCKVILLE, MD
SOUTH WINDSOR, CT - BOSTON, MA -
NEW BEDFORD, MA - HOLYOKE, MA

125 BROAD STREET, 5TH FLOOR
BOSTON, MA 02210
58H CONNECTICUT AVENUE
SOUTH WINDSOR, CT

The drawings prepared by Apex for this project are the property of Apex and are to be used only for the project and general use as intended. Apex shall not be held responsible for any errors, omissions, or for any liability and other reserved rights with respect to the drawings, including the copyright. The drawings shall not be used on other projects, for addition to this project or for completion of this project by others, except by agreement in writing and with appropriate compensation to Apex.

PROJECT	NEW BEDFORD HARBOR DEVELOPMENT COMMISSION LOWER HARBOR CAD CELL	
	OWNER	NEW BEDFORD HARBOR DEVELOPMENT COMMISSION 52 FISHERMAN'S WHARF, NEW BEDFORD, MA 02740

1	9/25/2012	EPA COMMENTS	GCD
2	2/21/2013	DRAFT SUITABILITY	MCK

DATE	DESCRIPTION	BY
PROJECT NO.	6724	
CADD FILE		
DESIGNED BY	CHM	
DRAWN BY	GCD	
CHECKED BY	GCD	
DATE	MAY 2013	
DRAWING SCALE	AS NOTED	

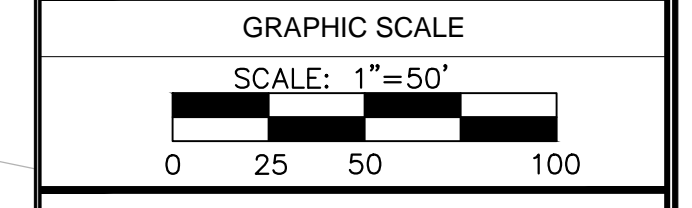

SHEET TITLE

BOTTOM OF LOWER HARBOR CAD CELL PHASE 1 WATER QUALITY
1/19/14- 1/25/14

DRAWING NO.

WQM-1

6 OF 15